

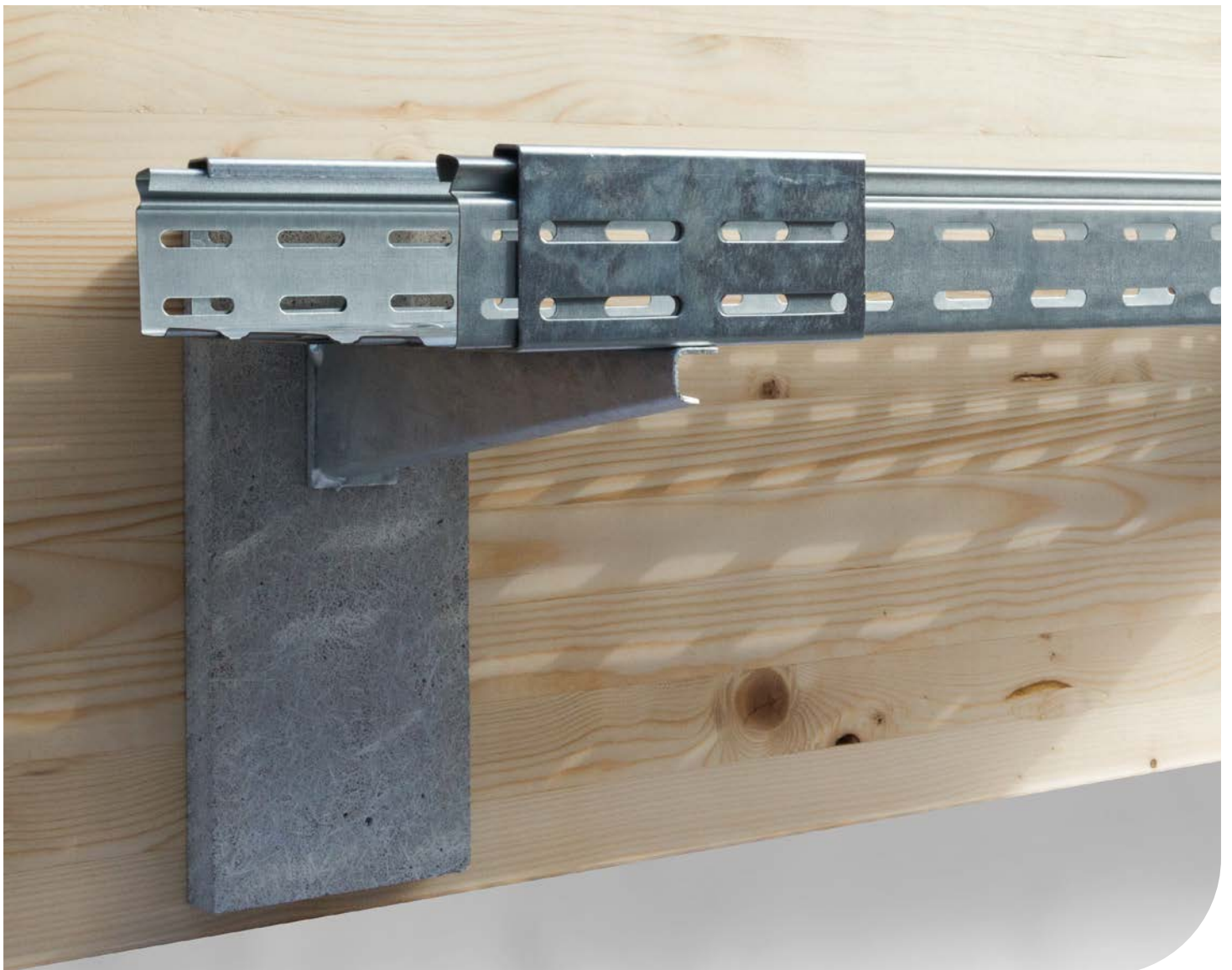

## Maintenance of function on wood Information



## Maintenance of function on wood Informationen

With the subject: Fastening of cable tray systems on wood constructions according to the maintenance of function, PUK Group GmbH & Co. KG replenishes its field of cable tray applications with a new, exciting addition. The wood constructions own the fire protection classification F30 or F60 in regard to DIN 4102-2. Detailed information and requirements are given through the expert's report no.

GA-2017/06/8-Mey from August 21, 2017 (by IBB-GmbH Ingenieurbüro für Brandschutz von Bauarten). The necessary product for a correct assembling e.g. a ready-to-use fire protection plate or required wood screws are listed below.

### Application examples



#### Assembly sideways onto the wood construction via suspension with a threaded rod GB

Fastening via a fiber cement plate (BSP), corner brace (W-BS), threaded rod (GB), bracket adapter (KAW-BS) and wall bracket (KW) to lay the cable tray (RGS 60) and the cable ladder (LGG-BS 60). Duct run in longitudinal direction and fastening sideways onto the wood construction.

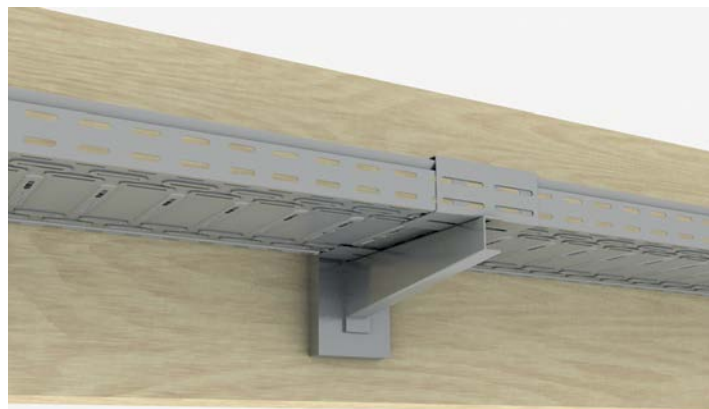

#### Assembly sideways onto the wood construction only with a wall bracket KWMS

Fastening via fiber cement plate (BSP) and wall bracket (KWMS) to lay the cable tray (RG 60). Duct run in longitudinal direction and fastening sideways onto the wood construction.



#### Assembly under the wood construction with bracket support KDU

Suspension via a fiber cement plates (BSP), bracket support (KDU) and wall bracket (KWMS) to lay the cable tray (RG 60). Duct run in longitudinal direction and fastening under the wood construction.



#### Assembly sideways onto the wood construction via suspension with KHA-Profil

Suspension via fiber cement plate (BSP), corner strap (BL), threaded rods (GB) and KHA-Profil to lay the cable tray (RGS 60) and the cable ladder (LGG-BS 60). Duct run in longitudinal direction and fastening sideways onto the wood construction.

# Maintenance of function on wood

## Product overview

### BSP 155 Fiber cement plate

article number	design	H mm	B mm	t mm	G kg
<b>FZ</b>					
<b>BSP 155x120x20FZ</b>	tailored, pre-drilled	155	120	20	0.25
<b>BSP 155x120x30FZ</b>	tailored, pre-drilled	155	120	30	0.38

accessories optional:  
**W-BS** wall angle  
**BL 5** corner angle

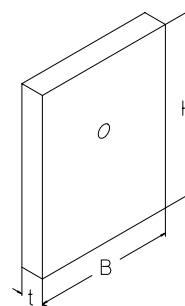

### BSP 266 Fiber cement plate

article number	design	H mm	B mm	t mm	G kg
<b>FZ</b>					
<b>BSP 266x120x20FZ</b>	tailored, pre-drilled	266	120	20	0.45
<b>BSP 266x120x30FZ</b>	tailored, pre-drilled	266	120	30	0.69

accessories optional:  
**KW-BS** bracket, fire protection  
**KWMS** wall bracket, medium duty  
**KHU 60** bracket support, profile U60  
**KDU 57** bracket support, 57 x 30 mm  
**KDU 60** bracket support, heavy, 60 x 40 mm

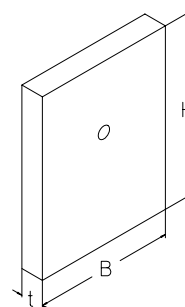

### BSP 600 Fiber cement plate

article number	design	H mm	B mm	t mm	G kg
<b>FZ</b>					
<b>BSP 600x120x20FZ</b>	individual cut, not pre-drilled, universally usable	600	120	20	1.01
<b>BSP 600x120x30FZ</b>	individual cut, not pre-drilled, universally usable	600	120	30	1.47

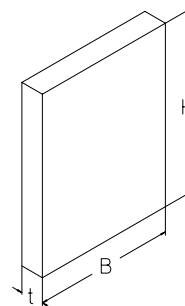

### HT wood screw

article number	L mm	Ø mm	G kg/100
<b>GV</b>			
<b>HT 6x60GV</b>	60	6	0.90
<b>HT 6x80GV</b>	80	6	1.10
<b>HT 6x100GV</b>	100	6	1.30
<b>HT 10x80GV</b>	80	10	3.10
<b>HT 10x100GV</b>	100	10	3.70
<b>HT 10x120GV</b>	120	10	4.30
<b>HT 10x140GV</b>	140	10	4.90



# Maintenance of function on wood

## Product overview

### GBAH-BS suspension of threaded rods

article number	L mm	G kg
<b>F</b>		
<b>GBAH-BS 115F</b>	115	0.17

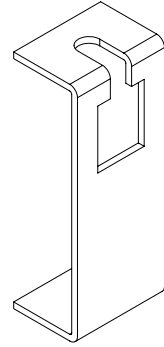

### TB Torx bit

article number	L mm	Ø mm	G kg
<b>GV</b>			
<b>TB 40x150</b>	150	40	0.04



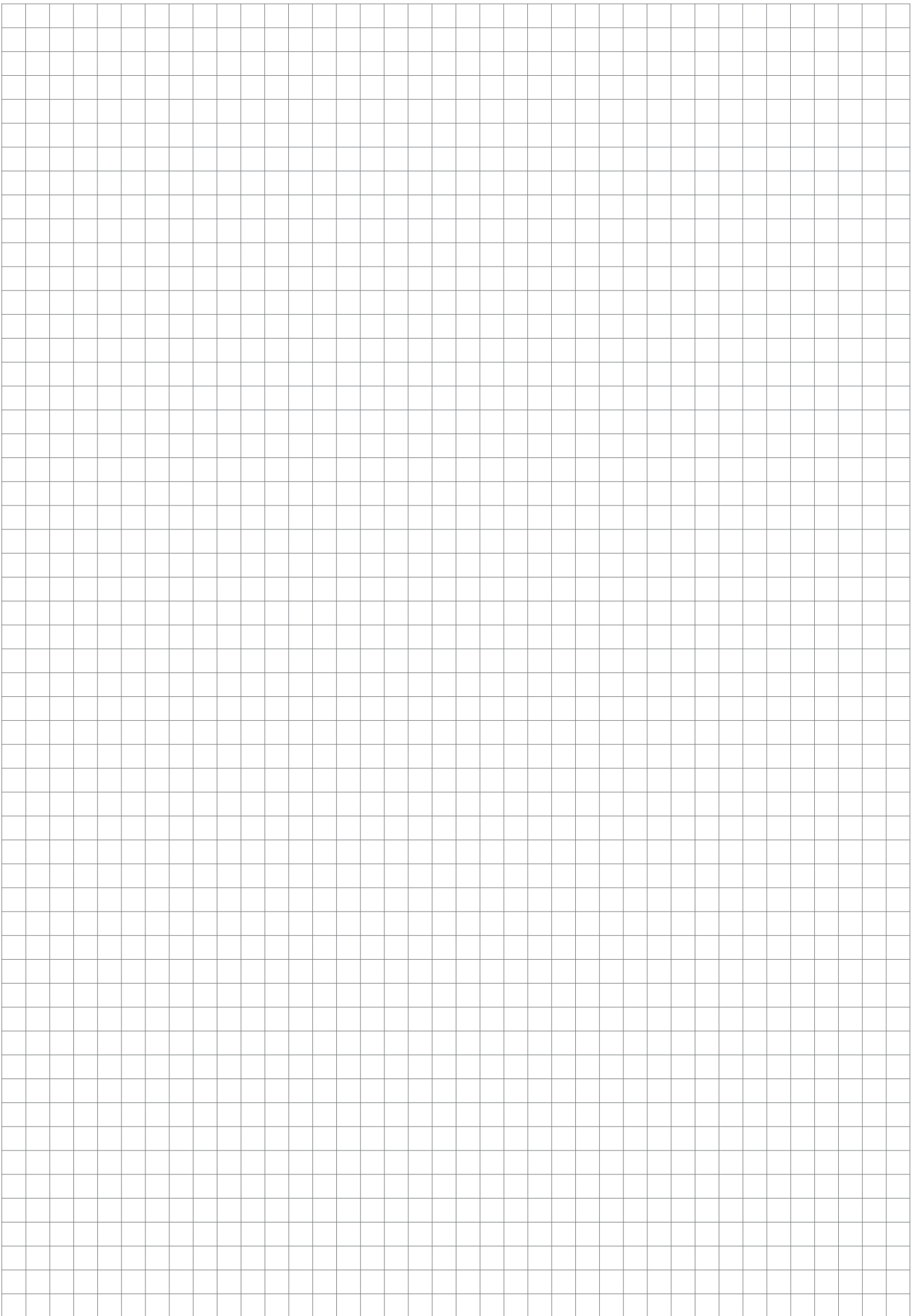



Errors and technical modification subject to change. Reproduction as well as electronic duplication only with our written permission. With appearance of this print all preceding documents lose their validity.

