

To be filled by PohlCon  
(S.-No.)  
\_\_\_\_\_

# ORDER FORM

## PENTAFLEX® Shuttering element

BP02a  
Stand: 2023-03-16

Customer:	Project:
Com.:	Element:

### Type ABS (Floor-Floor / Ceiling-Ceiling)

For sealed joints between two slabs, with one Floor-Wall joint

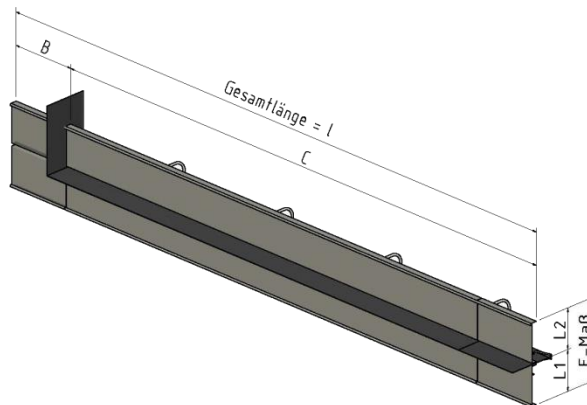

### Profile

ABS-R<sub>(coarse)</sub>  
E (mm): 80-590

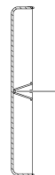

ABS-V<sub>(interlocking)</sub>  
E (mm): 140-590

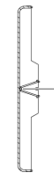

ABS-VS<sub>(interlocking)</sub>  
E (mm): 600-2240



### Measurements

L = \_\_\_\_\_ mm For lengths over 2,40 m, the delivery will be of at least two pieces

E = \_\_\_\_\_ mm B = \_\_\_\_\_ mm

D = \_\_\_\_\_ mm

### Joint position

Centered

Not-centered L1 = \_\_\_\_\_ mm L2 = \_\_\_\_\_ mm

### Joint variant

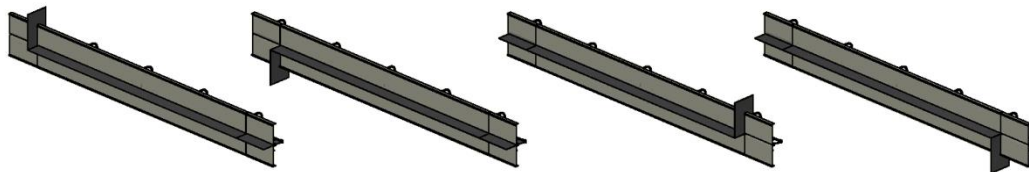

### Comments

Authorized by: \_\_\_\_\_ on the: \_\_\_\_\_

Subject to change for technical production reasons