

To be completed by
H-BAU Technik (S.-no.)

ORDER FORM

KUNEX® external expansion joint tape with FBA

BK41

Rev. 00 vom: 2023-03-13

Customer:	Project:
Com.:	Element:

Joint tape requirements

- DIN 18541 BV (bitumen-compatible)
- DIN 18541 NB (non bitumen compatible)
- factory standard NB (according to abP, non bitumen compatible)

Joint tape selection

- DA240/20
- DA240/35
- DA320/20*
- DA320/25
- DA320/35
- DA500/35

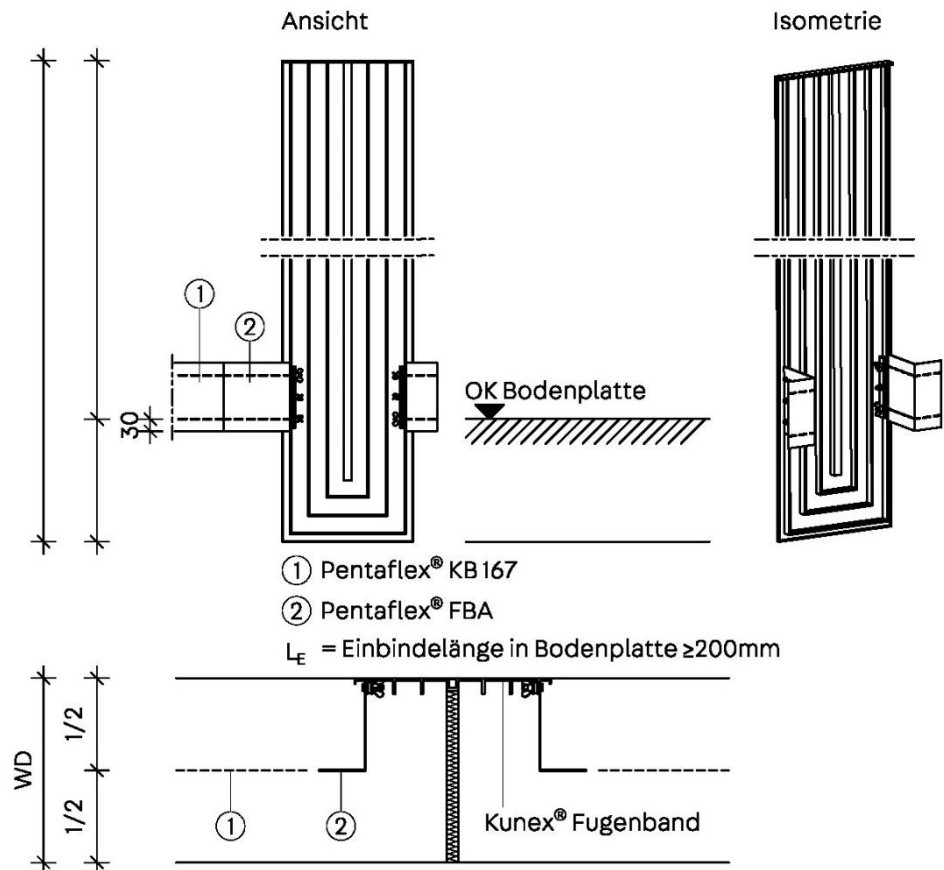

Manufacturing tolerances according to
DIN 16941 and DIN 18020 table 1:

Length $\leq 3000\text{mm}$ = $\pm 15\text{mm}$
Length $3000\text{mm} - 6000\text{mm}$ = $\pm 20\text{mm}$
Length $> 6000\text{mm}$ = $\pm 30\text{mm}$

Note:
Dimensional deviations of up to 3% are possible due to
external influences such as temperature and storage
conditions.

The Pentaflex® FBA is not
included in the scope of delivery.
This must be ordered separately.

*Not available in DIN quality