

UKEF160 V

stainless steel hinged cover compact single-outlet, quadruple, angular, flat

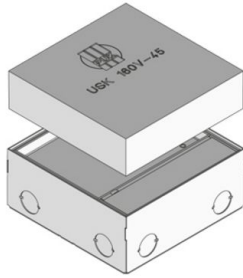

Consisting of floor box inclusive square single outlet and shuttering formwork, as concealed shuttering for direct installation in floor screed. As height-adjustable cassette installation frame with cable outlet cassette, welt, automatic-closure opening lever, floor-level cable outlet and rubber seal to accommodate up to two 45x45mm installed devices. With perforations on the side panels for the introduction of tubes M25. Suitable for rooms with dry and damp-cleaned floor covers. Designed for office traffic loads.



| | |
|---------|---------------------------|
| norm | according to DIN EN 50085 |
| permits | according to VDE / TÜV |

Stainless steel, according to ASTM 304 / BS 304 S 3

| Product | H | H _{min} | N | B | L | E | T | P _{max} | IP _n | IP _g | G |
|----------------|-------|------------------|-------|--------|--------|--------------|-------|------------------|-----------------|-----------------|---------|
| UKEF160 15-V E | 15 mm | 70 mm | 20 mm | 160 mm | 160 mm | 166 x 166 mm | 12 mm | 2 kN | IP 30 | IP 20 | 2,05 kg |

- H:** height
- H_{min}:** Minimum installation height
- N:** levelling range
- B:** width
- L:** length
- E:** fitting dimension
- T:** depth
- P_{max}:** Maximum load
- IP_n:** IP protection level in unused condition
- IP_g:** IP protection level in used condition
- G:** weight

DETAILS / APPLICATIONS



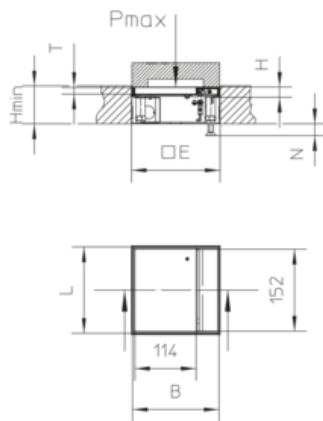

OPTIONAL ACCESSORIES

UKENP 160



dry-cleaned

