

UKE125 V

stainless steel hinged cover compact single-outlet, double, angular

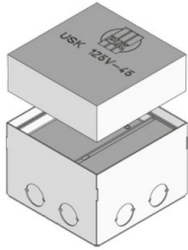

Consisting of floor box inclusive square single outlet and shuttering formwork, as concealed shuttering for direct installation in floor screed. As height-adjustable cassette installation frame with cable outlet cassette, welt, automatic-closure opening lever, floor-level cable outlet and rubber seal to accommodate up to two 45x45mm installed devices and two single data jacks. With perforations on the side panels for the introduction of tubes M25. Suitable for rooms with dry and damp-cleaned floor covers. Designed for office traffic loads.



norm	according to DIN EN 50085
permits	according to VDE / TÜV

Stainless steel, according to ASTM 304 / BS 304 S 3

Product	H	H _{min}	N	B	L	E	T	P _{max}	IP _n	IP _g	G
UKE125 15-V E	15 mm	90 mm	35 mm	125 mm	125 mm	131 x 131 mm	12 mm	2 kN	IP 30	IP 20	1,74 kg
UKE125 25-V E	25 mm	100 mm	35 mm	125 mm	125 mm	131 x 131 mm	22 mm	2 kN	IP 30	IP 20	1,97 kg

Brass

Product	H	H _{min}	N	B	L	E	T	P _{max}	IP _n	IP _g	G
UKE125 25-V MS	25 mm	100 mm	35 mm	125 mm	125 mm	131 x 131 mm	19 mm	2 kN	IP 30	IP 20	2,24 kg

H: height
H_{min}: Minimum installation height
N: levelling range
B: width
L: length



E: fitting dimension
T: depth
P_{max}: Maximum load
IP_n: IP protection level in unused condition
IP_g: IP protection level in used condition
G: weight

DETAILS / APPLICATIONS

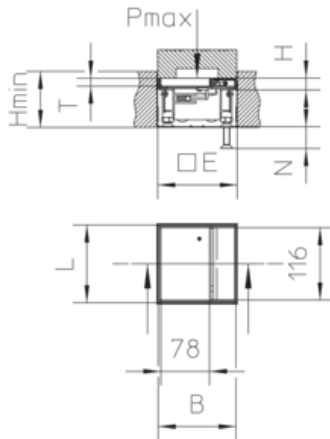

OPTIONAL ACCESSORIES

UEP125 KS, UEP125 UST, UEP125 B, UKENP 125



dry-cleaned

