

UEKD RP E

stainless steel hinged cover unit, triple, round, plane

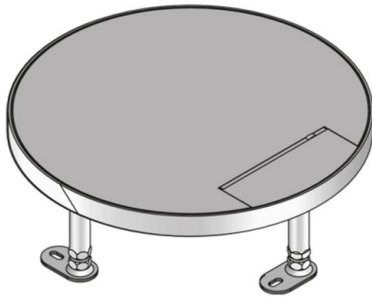

Round cartridge made of flat stainless steel, surface blasted, with hem. As levelling cartridge installation frame with cable outlet cartridge, floor-level cable outlet, self-closing opening lever and rubber seal for the installation into floor boxes, assembly covers and raised or hollow floor openings. To accommodate up to 3 mounting boxes equipped with up to 9 suspension bracket installation devices or 12 installation devices of 45x45 mm. Suitable for rooms with dry and damp-cleaned floor covers. Designed for office traffic loads.

Please mind the technical information in chapter planning.



material	Cartridge with cable outlet and frame: stainless steel
type of assembly	To be mounted in floor box UBDHB respectively hollow floors.
application area	dry floor cleaning
protection class	in use IP 20 / not in use IP 30
norm	according to DIN EN 50085
permits	according to VDE / TÜV
loading	including inspection stamp Ø13 / 130 mm: 4 / 10 kN

Stainless steel, according to ASTM 304 / BS 304 S 3

Product	H	H _{min}	N	B	E	P _{max}	IP _n	IP _g	G
UEKD 15-RP E	21 mm	100 mm	55 mm	305 mm	307 mm	4 kN	IP 30	IP 20	3,25 kg
incl.:									
1x UGD-R 10-2									rubber seal, round

H: height
H_{min}: Minimum installation height
N: levelling range
B: width
E: fitting dimension
P_{max}: Maximum load
IP_n: IP protection level in unused condition



IP_g: IP protection level in used condition
G: weight

DETAILS / APPLICATIONS

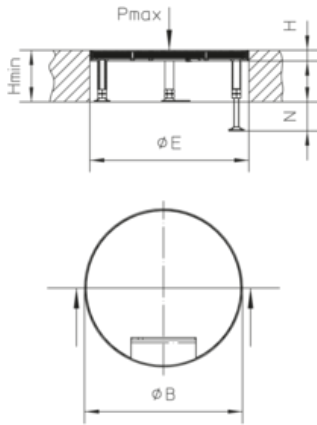

OPTIONAL ACCESSORIES

UGEAR, UBDSLFL, UGM SLF



dry-cleaned

