

## UEBDSM1-2 V WD

stainless steel heavy-duty tube cover single-outlet cartridge, double, angular

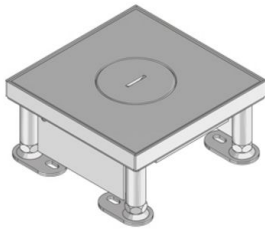

Square single outlet made of flat stainless steel, surface blasted, with welt to accommodate two 45x45 mm module units. As a height-adjustable cartridge installation frame with heavy-duty tube outlet cartridge, screwed-on tube mounting set and rubber seal. For the installation into floor boxes and raised or hollow floor openings. Suitable for rooms with wet-cleaned floor covers. Designed for high traffic loads.

Please mind the technical information in chapter planning.



material	cartridge and frame: 2mm high-grade steel V2A, sub construction: sheet steel galvanized
type of assembly	Assembly on floor box UBDHB / rough concrete ceiling
application area	wet floor cleaning
protection class	in use IP 22 / not in use IP 54
norm	according to DIN EN 50085
permits	according to VDE / TÜV
loading	including inspection stamp Ø 130 mm: 20 kN

### Stainless steel, according to ASTM 304 / BS 304 S 3

Product	H	H <sub>min</sub>	N	B	L	E	P <sub>max</sub>	IP <sub>n</sub>	IP <sub>g</sub>	G
UEBDSM1-2 15-V8-WD	19 mm	80 mm	45 mm	160 mm	160 mm	164 x 164 mm	20 kN	IP 54	IP 22	4,39 kg
incl.:										
1x UGD1-2-V 2				rubber seal, angular						
1x UETD-R-WD				tube cover						

**H:** height  
**H<sub>min</sub>:** Minimum installation height  
**N:** levelling range  
**B:** width  
**L:** length



**E:** fitting dimension  
**P<sub>max</sub>:** Maximum load  
**IP<sub>n</sub>:** IP protection level in unused condition  
**IP<sub>g</sub>:** IP protection level in used condition  
**G:** weight

## DETAILS / APPLICATIONS

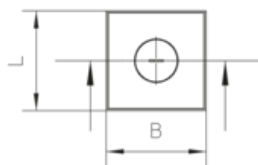
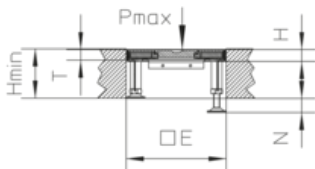

## OPTIONAL ACCESSORIES

UGEAV1-2, UGR1-4, UET WD



wet-cleaned

