

UEBDM2 R WD

stainless steel tube cover unit, double, round

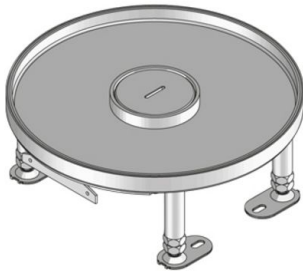

Round cartridge made of stainless steel sheet with hem. As a levellable cartridge installation frame with a tube outlet cartridge, a screwed-on aluminum tube mounting set and a rubber seal for the installation into floor boxes, assembly covers and raised or hollow floor openings. To accommodate up to 2 mounting boxes equipped with up to 6 suspension bracket installation devices or 8 installation devices of 45x45mm. Suitable for rooms with wet-cleaned floor covers. Designed for office traffic loads.

Please mind the technical information in chapter planning.



material	Cassette: 2 mm stainless steel V2A, frame: 1.5 mm stainless steel V2A
type of assembly	Assembly in floor box UBDHB, double or hollow floor openings
application area	wet floor cleaning
protection class	in use IP 22 / not in use IP 54
norm	according to DIN EN 50085
permits	according to VDE / TÜV
loading	including inspection stamp Ø 13 / 130 mm: 2 / 3 kN

Aluminium

Product	H	H _{min}	N	B	E	T	P _{max}	IP _n	IP _g	G
UEBDM2 15-R-WD	18 mm	100 mm	55 mm	258 mm	260 mm	12 mm	2 kN	IP 54	IP 22	2,21 kg
incl.:										
1x UGDB15-R300 1.8					rubber seal, round					
1x UGD2-R 10-2					rubber seal, round					
1x UETD-R-WD					tube cover					
UEBDM2 25-R-WD	28 mm	110 mm	55 mm	258 mm	260 mm	22 mm	2 kN	IP 54	IP 22	2,24 kg



Product	H	H _{min}	N	B	E	T	P _{max}	IP _n	IP _g	G
incl.:										
1x UGDB15-R300 1.8										rubber seal, round
1x UGD2-R 10-2										rubber seal, round
1x UETD-R-WD										tube cover

- H:** height
- H_{min}:** Minimum installation height
- N:** levelling range
- B:** width
- E:** fitting dimension
- T:** depth
- P_{max}:** Maximum load
- IP_n:** IP protection level in unused condition
- IP_g:** IP protection level in used condition
- G:** weight

DETAILS / APPLICATIONS

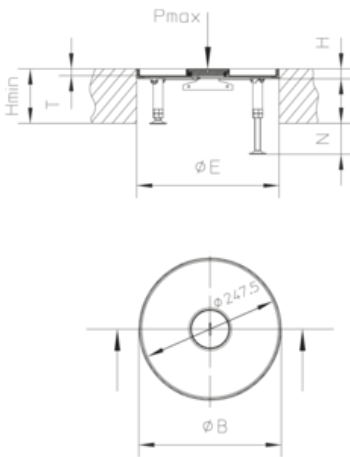

OPTIONAL ACCESSORIES

UGEAR2, UET WD, UBDSLFL, UGM SLF



wet-cleaned

