

UEBDD2 V E

stainless steel dummy cover cartridge, double, angular

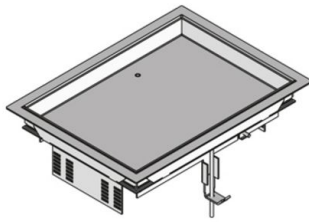

Quadrangular installation unit with high-grade steel carpet protection frame. As cartridge installation frame with dummy inlay cartridge, rubber seal and a universal mounting claw set. For the installation into floor boxes, assembly covers, raised floor/hollow floor openings. Suitable for rooms with dry or wet-cleaned floor covers. Quadrangular installation unit with high-grade steel carpet protection frame. As cartridge installation frame with dummy inlay cartridge, rubber seal and a universal mounting claw set. For the installation into floor boxes, assembly covers and into raised or hollow floor openings. Suitable for rooms with dry and damp-cleaned floor covers. Designed for office traffic loads.

Please mind the technical information in chapter planning.



material	cartridge and frame: 2 mm high-grade steel V2A
type of assembly	Assembly in floor box UBDHB, double or hollow floor openings
application area	dry floor cleaning
protection class	not in use IP 30
norm	according to DIN EN 50085
permits	according to VDE / TÜV
loading	including inspection stamp Ø 13 mm: 1.5 kN

Stainless steel, according to ASTM 304 / BS 304 S 3

Product	H	H _{min}	B	L	E	T	P _{max}	IP _n	G
UEBDD2 15-V E	72 mm	90 mm	210 mm	283 mm	261 x 186 mm	12 mm	1,5 kN	IP 30	1,71 kg
incl.:									
1x UGD2-V 2				rubber seal, angular					
2x UDBS 40-80				special claw					
UEBDD2 25-V E	82 mm	100 mm	210 mm	283 mm	261 x 186 mm	22 mm	1,5 kN	IP 30	2,50 kg



Product	H	H _{min}	B	L	E	T	P _{max}	IP _n	G
incl.:									
1x UGD2-V 2				rubber seal, angular					
2x UDBS 40-80				special claw					

H: height
H_{min}: Minimum installation height
B: width
L: length
E: fitting dimension
T: depth
P_{max}: Maximum load
IP_n: IP protection level in unused condition
G: weight

DETAILS / APPLICATIONS

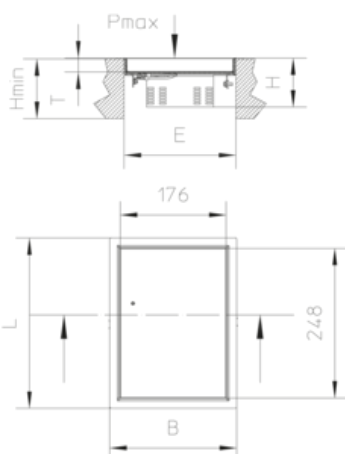

OPTIONAL ACCESSORIES

UDBS 40-80



dry-cleaned

