

## UEBD1-1 V E

stainless steel dummy cover single-outlet cartridge, single, angular

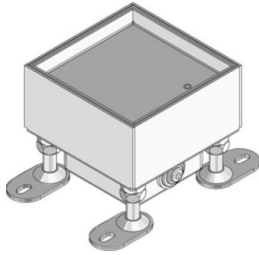

Quadrangular single outlet made of high-grade steel with a hem as retainer for one 45x45 mm device. As levellable cartridge installation frame with dummy cartridge, retainer box and rubber seal. For direct installation into screed or hollow floors. Suitable for wet-cleaned floors. For office working loads.

Please mind the technical information in chapter planning.



material	cartridge and frame: 2mm high-grade steel V2A, sub construction: sheet steel galvanized
type of assembly	Mounting on raw concrete ceiling
application area	wet floor cleaning
protection class	not in use IP 54
norm	according to DIN EN 50085
permits	according to VDE / TÜV
loading	including inspection stamp Ø 13 / 130 mm: 2 / 3 kN

Stainless steel, according to ASTM 304 / BS 304 S 3

Product	H <sub>min</sub>	N	B	L	E	T	P <sub>max</sub>	IP <sub>n</sub>	G
UEBD1-1 15-V E	100 mm	20 mm	115 mm	115 mm	115 x 115 mm	12 mm	2 kN	IP 54	2,2 kg
incl.:									
1x UGD1-1-V 2									rubber seal, square

**H<sub>min</sub>**: Minimum installation height

**N**: levelling range

**B**: width

**L**: length

**E**: fitting dimension

**T**: depth

**P<sub>max</sub>**: Maximum load

**IP<sub>n</sub>**: IP protection level in unused condition

**G**: weight



## DETAILS / APPLICATIONS

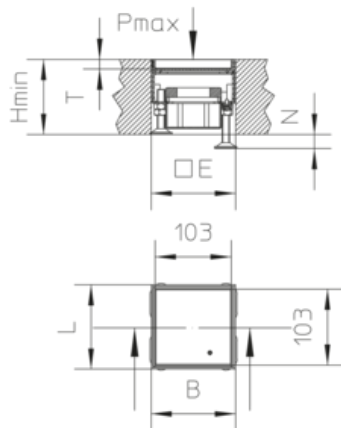

## OPTIONAL ACCESSORIES

UST45 1, UDAE22



wet-cleaned

