

UBEBMBI

inside bend

Inside bend as accessory for the screed-flush brush duct.

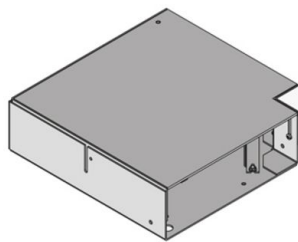

Continuously hot galvanized (Sendzimir process) (DIN EN 10346)

Product	B	L	G
UBEBMBI 85-25S	295 mm	295 mm	5,44 kg

B: width
L: length
G: weight

DETAILS / APPLICATIONS

