

KWMS

wall/handle bracket, medium duty

Wall/handle bracket, medium-heavy version, with welded-on back plate. Certified according to DIN EN 61537. For mounting on walls or hanging struts.

F_D/P : coefficient for calculation of the dowel load F_D with effective bracket load P respectively the sum of effective bracket loads. The load specifications are only valid with sufficient anchoring to the load-bearing substrate or with proper installation on hanging struts.

galvanized, according to DIN EN ISO 19598 / DIN EN ISO 2081

| Product | H | B1 | B2 | L | P_{max} | F_D/P | G |
|------------|--------|--------|--------|--------|-----------|---------|---------|
| KWMS 010GV | 110 mm | 100 mm | 115 mm | 128 mm | 3,8 kN | 1,36 | 0,50 kg |
| KWMS 020GV | 110 mm | 200 mm | 215 mm | 228 mm | 3,8 kN | 1,81 | 0,71 kg |
| KWMS 030GV | 110 mm | 300 mm | 315 mm | 328 mm | 3,8 kN | 2,32 | 0,92 kg |
| KWMS 040GV | 110 mm | 400 mm | 415 mm | 428 mm | 3,8 kN | 2,86 | 1,13 kg |
| KWMS 050GV | 110 mm | 500 mm | 515 mm | 528 mm | 3,8 kN | 3,42 | 1,34 kg |
| KWMS 060GV | 110 mm | 600 mm | 615 mm | 628 mm | 3,8 kN | 3,99 | 1,54 kg |

Hot-dip galvanized, according to BS 729 (DIN EN ISO 1461)

| Product | H | B1 | B2 | L | P_{max} | F_D/P | G |
|-----------|--------|--------|--------|--------|-----------|---------|---------|
| KWMS 010F | 110 mm | 100 mm | 115 mm | 128 mm | 3,8 kN | 1,36 | 0,53 kg |
| KWMS 020F | 110 mm | 200 mm | 215 mm | 228 mm | 3,8 kN | 1,81 | 0,76 kg |
| KWMS 030F | 110 mm | 300 mm | 315 mm | 328 mm | 3,8 kN | 2,32 | 0,99 kg |
| KWMS 040F | 110 mm | 400 mm | 415 mm | 428 mm | 3,8 kN | 2,86 | 1,21 kg |
| KWMS 050F | 110 mm | 500 mm | 515 mm | 528 mm | 3,8 kN | 3,42 | 1,43 kg |
| KWMS 060F | 110 mm | 600 mm | 615 mm | 628 mm | 3,8 kN | 3,99 | 1,65 kg |

Stainless steel, according to ASTM 304 / BS 304 S 3



| Product | H | B1 | B2 | L | P _{max} | F _D /P | G |
|-----------|--------|--------|--------|--------|------------------|-------------------|---------|
| KWMS 010E | 110 mm | 100 mm | 115 mm | 128 mm | 3,8 kN | 1,36 | 0,51 kg |
| KWMS 020E | 110 mm | 200 mm | 215 mm | 228 mm | 3,8 kN | 1,81 | 0,73 kg |
| KWMS 030E | 110 mm | 300 mm | 315 mm | 328 mm | 3,8 kN | 2,32 | 0,94 kg |
| KWMS 040E | 110 mm | 400 mm | 415 mm | 428 mm | 3,8 kN | 2,86 | 1,16 kg |
| KWMS 050E | 110 mm | 500 mm | 515 mm | 528 mm | 3,8 kN | 3,42 | 1,37 kg |
| KWMS 060E | 110 mm | 600 mm | 615 mm | 628 mm | 3,8 kN | 3,99 | 1,58 kg |

Stainless steel, according to ASTM 31 Ti / AISI 316 L, BS 320S17 / BS 316S11

| Product | H | B1 | B2 | L | P _{max} | F _D /P | G |
|------------|--------|--------|--------|--------|------------------|-------------------|---------|
| KWMS 010E4 | 110 mm | 100 mm | 115 mm | 128 mm | 3,8 kN | 1,36 | 0,52 kg |
| KWMS 020E4 | 110 mm | 200 mm | 215 mm | 228 mm | 3,8 kN | 1,81 | 0,74 kg |
| KWMS 030E4 | 110 mm | 300 mm | 315 mm | 328 mm | 3,8 kN | 2,32 | 0,95 kg |
| KWMS 040E4 | 110 mm | 400 mm | 415 mm | 428 mm | 3,8 kN | 2,86 | 1,17 kg |
| KWMS 050E4 | 110 mm | 500 mm | 515 mm | 528 mm | 3,8 kN | 3,42 | 1,38 kg |
| KWMS 060E4 | 110 mm | 600 mm | 615 mm | 628 mm | 3,8 kN | 3,99 | 1,60 kg |

H: height
B1: width
B2: width
L: length
P_{max}: Maximum load
F_D/P: dowel-to-anchor load
G: weight

DETAILS / APPLICATIONS



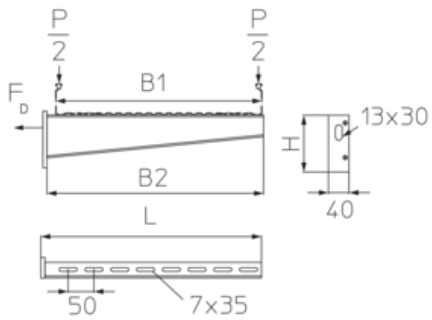

OPTIONAL ACCESSORIES

KDU 57, KHU 57, KDU 60, KDU 60, SD, KLR

