

KWLL

wall bracket, light-duty

Wall bracket, light-duty version, made of profile rail 30x15 mm, slot width 16 mm. For mounting on walls.

F_D/P : coefficient for calculation of the dowel load F_D with effective bracket load P respectively the sum of effective bracket loads. This article is available made in material No. 1.4571/1.4404 (V4A) stainless steel finish.

Continuously hot galvanized (Sendzimir process) (DIN EN 10346)

Product	H	B1	B2	L	P_{max}	F_D/P	G
KWLL 010S	80 mm	100 mm	110 mm	125 mm	0,3 kN	2,0	0,13 kg
KWLL 020S	80 mm	200 mm	210 mm	225 mm	0,3 kN	3,0	0,20 kg
KWLL 030S	80 mm	300 mm	310 mm	325 mm	0,3 kN	4,0	0,28 kg

Stainless steel, according to ASTM 304 / BS 304 S 3

Product	H	B1	B2	L	P_{max}	F_D/P	G
KWLL 010E	80 mm	100 mm	110 mm	125 mm	0,3 kN	2,0	0,13 kg
KWLL 020E	80 mm	200 mm	210 mm	225 mm	0,3 kN	3,0	0,21 kg
KWLL 030E	80 mm	300 mm	310 mm	325 mm	0,3 kN	4,0	0,28 kg

- H:** height
- B1:** width
- B2:** width
- L:** length
- P_{max} :** Maximum load
- F_D/P :** dowel-to-anchor load
- G:** weight



DETAILS / APPLICATIONS

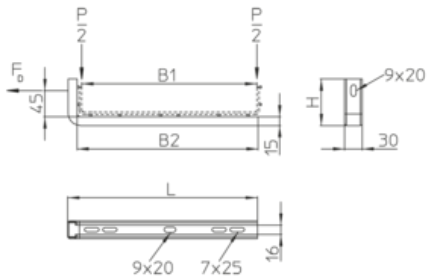

OPTIONAL ACCESSORIES

SD, KLR

