

KDU 57

bracket support, 57x30mm

Ceiling bracket support, U-profile 57x30x2.5 mm, continuously three-way perforated, with welded head plate (material thickness t), certified according to DIN EN 61537.

F_D/P : coefficient for calculation of the dowel load F_D with effective bracket load P. The permissible loads are achieved by means of a support piece. A support piece must be used from a console length of 400 mm or when mounting in the end area of the ceiling stem. For console lengths < 400 mm without using the support piece, the permissible loads must be reduced by 30 %.

galvanized, according to DIN EN ISO 19598 / DIN EN ISO 2081

Product	L	t	G
KDU 57-02GV	200 mm	5,00 mm	0,55 kg
KDU 57-03GV	300 mm	5,00 mm	0,72 kg
KDU 57-04GV	400 mm	5,00 mm	0,89 kg
KDU 57-05GV	500 mm	5,00 mm	1,06 kg
KDU 57-06GV	600 mm	5,00 mm	1,22 kg
KDU 57-07GV	700 mm	5,00 mm	1,39 kg
KDU 57-08GV	800 mm	5,00 mm	1,57 kg
KDU 57-09GV	900 mm	5,00 mm	1,74 kg
KDU 57-10GV	1000 mm	5,00 mm	1,91 kg
KDU 57-11GV	1100 mm	5,00 mm	2,07 kg
KDU 57-12GV	1200 mm	5,00 mm	2,25 kg
KDU 57-13GV	1300 mm	5,00 mm	2,41 kg
KDU 57-14GV	1400 mm	5,00 mm	2,59 kg
KDU 57-15GV	1500 mm	5,00 mm	2,76 kg

Hot-dip galvanized, according to BS 729 (DIN EN ISO 1461)

Product	L	t	G
KDU 57-02F	200 mm	5,00 mm	0,59 kg



Product	L	t	G
KDU 57-03F	300 mm	5,00 mm	0,77 kg
KDU 57-04F	400 mm	5,00 mm	0,95 kg
KDU 57-05F	500 mm	5,00 mm	1,13 kg
KDU 57-06F	600 mm	5,00 mm	1,31 kg
KDU 57-07F	700 mm	5,00 mm	1,49 kg
KDU 57-08F	800 mm	5,00 mm	1,68 kg
KDU 57-09F	900 mm	5,00 mm	1,86 kg
KDU 57-10F	1000 mm	5,00 mm	2,04 kg
KDU 57-11F	1100 mm	5,00 mm	2,22 kg
KDU 57-12F	1200 mm	5,00 mm	2,40 kg
KDU 57-13F	1300 mm	5,00 mm	2,58 kg
KDU 57-14F	1400 mm	5,00 mm	2,77 kg
KDU 57-15F	1500 mm	5,00 mm	2,95 kg

Stainless steel, according to ASTM 304 / BS 304 S 3

Product	L	t	G
KDU 57-02E	200 mm	5,00 mm	0,57 kg
KDU 57-03E	300 mm	5,00 mm	0,74 kg
KDU 57-04E	400 mm	5,00 mm	0,91 kg
KDU 57-05E	500 mm	5,00 mm	1,08 kg
KDU 57-06E	600 mm	5,00 mm	1,25 kg
KDU 57-07E	700 mm	5,00 mm	1,42 kg
KDU 57-08E	800 mm	5,00 mm	1,59 kg
KDU 57-09E	900 mm	5,00 mm	1,76 kg
KDU 57-10E	1000 mm	5,00 mm	1,93 kg
KDU 57-11E	1100 mm	5,00 mm	2,10 kg
KDU 57-12E	1200 mm	5,00 mm	2,27 kg
KDU 57-13E	1300 mm	5,00 mm	2,44 kg
KDU 57-14E	1400 mm	5,00 mm	2,61 kg
KDU 57-15E	1500 mm	5,00 mm	2,78 kg



Stainless steel, according to ASTM 31 Ti / AISI 316 L, BS 320S17 / BS 316S11

Product	L	t	G
KDU 57-02E4	200 mm	5,00 mm	0,57 kg
KDU 57-03E4	300 mm	5,00 mm	0,74 kg
KDU 57-04E4	400 mm	5,00 mm	0,91 kg
KDU 57-05E4	500 mm	5,00 mm	1,08 kg
KDU 57-06E4	600 mm	5,00 mm	1,25 kg
KDU 57-07E4	700 mm	5,00 mm	1,42 kg
KDU 57-08E4	800 mm	5,00 mm	1,59 kg
KDU 57-09E4	900 mm	5,00 mm	1,76 kg
KDU 57-10E4	1000 mm	5,00 mm	1,93 kg
KDU 57-11E4	1100 mm	5,00 mm	2,10 kg
KDU 57-12E4	1200 mm	5,00 mm	2,27 kg
KDU 57-13E4	1300 mm	5,00 mm	2,44 kg
KDU 57-14E4	1400 mm	5,00 mm	2,61 kg
KDU 57-15E4	1500 mm	5,00 mm	2,78 kg

L: length
t: material thickness
G: weight

DETAILS / APPLICATIONS

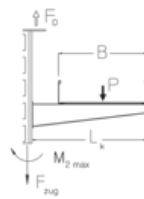
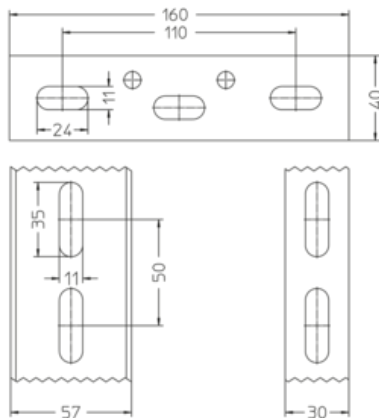

$$M_{2 \max} = 670 \text{ Nm}$$

$$F_{\text{zug}} = 15 \text{ kN}$$

B	L _k	P _{max}	F ₀ /P
mm	mm	kN	
100	120	6,9	1,4
200	220	4,5	1,9
300	320	3,4	2,3
400	420	2,7	2,8
500	520	2,2	3,2
600	620	1,9	3,7



OPTIONAL ACCESSORIES

KWF, KW, KWMS, KHU 57, KHUV 57, KHUSS 57, SU 57

