

## KDU 40

bracket support, 40x30 mm

Ceiling bracket support, U-profile 40x30x2 mm, continuously three-way perforated, with welded head plate (material thickness t), certified according to DIN EN 61537.

$F_D/P$ : coefficient for calculation of the dowel load  $F_D$  with effective bracket load P. The permissible loads are achieved by means of a support piece. A support piece must be used from a console length of 400 mm or when mounting in the end area of the ceiling stem. For console lengths < 400 mm without using the support piece, the permissible loads must be reduced by 30 %.

galvanized, according to DIN EN ISO 19598 / DIN EN ISO 2081

Product	L	t	G
KDU 40-02GV	200 mm	4,00 mm	0,36 kg
KDU 40-03GV	300 mm	4,00 mm	0,47 kg
KDU 40-04GV	400 mm	4,00 mm	0,58 kg
KDU 40-05GV	500 mm	4,00 mm	0,68 kg
KDU 40-06GV	600 mm	4,00 mm	0,80 kg
KDU 40-07GV	700 mm	4,00 mm	0,92 kg
KDU 40-08GV	800 mm	4,00 mm	1,03 kg
KDU 40-09GV	900 mm	4,00 mm	1,14 kg
KDU 40-10GV	1000 mm	4,00 mm	1,25 kg
KDU 40-11GV	1100 mm	4,00 mm	1,36 kg
KDU 40-12GV	1200 mm	4,00 mm	1,48 kg
KDU 40-13GV	1300 mm	4,00 mm	1,59 kg
KDU 40-14GV	1400 mm	4,00 mm	1,70 kg
KDU 40-15GV	1500 mm	4,00 mm	1,81 kg

Hot-dip galvanized, according to BS 729 (DIN EN ISO 1461)

Product	L	t	G
KDU 40-02F	200 mm	4,00 mm	0,38 kg

Page 1



Product	L	t	G
KDU 40-03F	300 mm	4,00 mm	0,50 kg
KDU 40-04F	400 mm	4,00 mm	0,62 kg
KDU 40-05F	500 mm	4,00 mm	0,73 kg
KDU 40-06F	600 mm	4,00 mm	0,86 kg
KDU 40-07F	700 mm	4,00 mm	0,98 kg
KDU 40-08F	800 mm	4,00 mm	1,10 kg
KDU 40-09F	900 mm	4,00 mm	1,22 kg
KDU 40-10F	1000 mm	4,00 mm	1,34 kg
KDU 40-11F	1100 mm	4,00 mm	1,46 kg
KDU 40-12F	1200 mm	4,00 mm	1,58 kg
KDU 40-13F	1300 mm	4,00 mm	1,70 kg
KDU 40-14F	1400 mm	4,00 mm	1,82 kg
KDU 40-15F	1500 mm	4,00 mm	1,94 kg

## Stainless steel, according to ASTM 304 / BS 304 S 3

Product	L	t	G
KDU 40-02E	200 mm	4,00 mm	0,36 kg
KDU 40-03E	300 mm	4,00 mm	0,47 kg
KDU 40-04E	400 mm	4,00 mm	0,60 kg
KDU 40-05E	500 mm	4,00 mm	0,70 kg
KDU 40-06E	600 mm	4,00 mm	0,81 kg
KDU 40-07E	700 mm	4,00 mm	0,92 kg
KDU 40-08E	800 mm	4,00 mm	1,03 kg
KDU 40-09E	900 mm	4,00 mm	1,15 kg
KDU 40-10E	1000 mm	4,00 mm	1,26 kg
KDU 40-11E	1100 mm	4,00 mm	1,40 kg
KDU 40-12E	1200 mm	4,00 mm	1,50 kg
KDU 40-13E	1300 mm	4,00 mm	1,60 kg
KDU 40-14E	1400 mm	4,00 mm	1,73 kg
KDU 40-15E	1500 mm	4,00 mm	1,83 kg



Stainless steel, according to ASTM 31 Ti / AISI 316 L, BS 320S17 / BS 316S11

Product	L	t	G
KDU 40-02E4	200 mm	4,00 mm	0,36 kg
KDU 40-03E4	300 mm	4,00 mm	0,47 kg
KDU 40-04E4	400 mm	4,00 mm	0,60 kg
KDU 40-05E4	500 mm	4,00 mm	0,70 kg
KDU 40-06E4	600 mm	4,00 mm	0,81 kg
KDU 40-07E4	700 mm	4,00 mm	0,92 kg
KDU 40-08E4	800 mm	4,00 mm	1,03 kg
KDU 40-09E4	900 mm	4,00 mm	1,16 kg
KDU 40-10E4	1000 mm	4,00 mm	1,26 kg
KDU 40-11E4	1100 mm	4,00 mm	1,40 kg
KDU 40-12E4	1200 mm	4,00 mm	1,50 kg
KDU 40-13E4	1300 mm	4,00 mm	1,61 kg
KDU 40-14E4	1400 mm	4,00 mm	1,73 kg
KDU 40-15E4	1500 mm	4,00 mm	1,84 kg

**L:** length  
**t:** material thickness  
**G:** weight

## DETAILS / APPLICATIONS

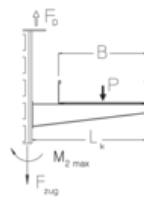
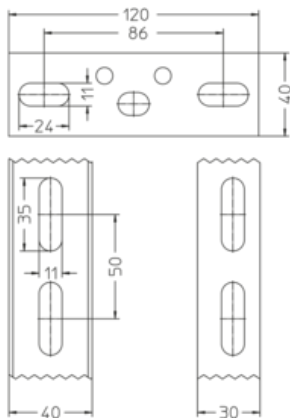

$$M_{2 \max} = 380 \text{ Nm}$$

$$F_{\text{zug}} = 10 \text{ kN}$$

B	L <sub>k</sub>	P <sub>max</sub>	F <sub>0</sub> /P
mm	mm	kN	
100	120	4,3	1,6
200	220	2,7	2,1
300	320	2,0	2,7
400	420	1,5	3,3



## OPTIONAL ACCESSORIES

KWF, KW, KHU 40, KHUV 40, KHUSS 40, SU 40

