

BODO T

single outlet with one floor socket, dry maintained, round

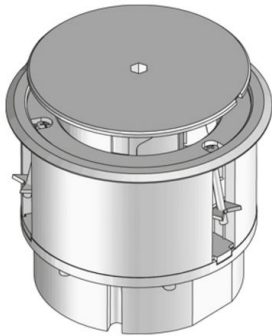

Round single-outlet made of plastic, equipped with an isolated ground receptacle and an empty space for data technology. With floor cover protection frame including a pivotable cover with cable outlet, mounting box with strain relief and a set of claws. For the installation into screed and raised floor/hollow floor openings. Equipped with a isolated ground receptacle of 45x45mm and a RJ45 dummy data cover 22.5x45 mm. Suitable for rooms with dry-cleaned floor covers. Designed for office traffic loads.

Please mind the technical information in chapter planning.



material	Cover with cable outlet and frame, mounting box: polyamide
type of assembly	Fixing on floor box UBDHB / rough concrete floor and installation in screed or false floor
application area	dry floor cleaning
protection class	in use IP 20 / not in use IP 30
norm	according to DIN EN 50085
permits	according to VDE / TÜV
loading	including inspection stamp Ø 13 mm: 1.5 kN

Acrylonitrile-butadiene-styrene copolymer

Product	H	H _{min}	B	E	P _{max}	color	IP _n	IP _g	G
BODO T-G	126 mm	102 mm	133 mm	122 mm	1,5 kN	RAL 7011 (iron grey)	IP 30	IP 20	0,40 kg
incl.:									
1x UAA-B 22		cover, black							
1x UST45-W 1		shockproof socket, single							
1x UARM-3-1 118		cover plate for 3x UDAE22							
1x UG-R		mounting box, round							
BODO T-S	126 mm	102 mm	133 mm	122 mm	1,5 kN	RAL 9011 (graphite black)	IP 30	IP 20	0,40 kg



Product	H	H _{min}	B	E	P _{max}	color	IP _n	IP _g	G
incl.:									
1x UAA-B 22					cover, black				
1x UST45-W 1					shockproof socket, single				
1x UARM-3-1 118					cover plate for 3x UDAE22				
1x UG-R					mounting box, round				

H: height
H_{min}: Minimum installation height
B: width
E: fitting dimension
P_{max}: Maximum load
color:
IP_n: IP protection level in unused condition
IP_g: IP protection level in used condition
G: weight

DETAILS / APPLICATIONS

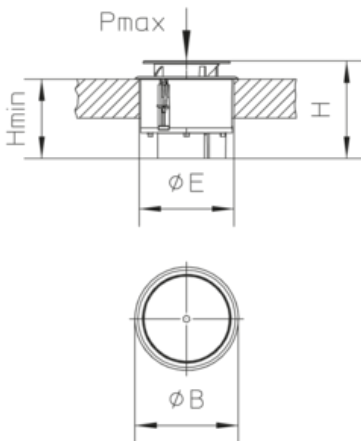

OPTIONAL ACCESSORIES

USK R122, UDKS R 1, UBDHB 122R, UWZ IS



dry-cleaned





Electrical and electronic equipment must not be disposed off via the household waste.

