

BKB 110

floor duct bend, height = 110 mm

floor duct bend 90° for horizontal change of direction with integrated connectors

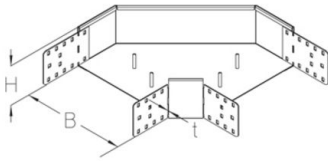

From a width ≥ 300 mm, one separating strip must be installed. From a width of ≥ 500 mm, two separating strips must be installed.

Continuously hot galvanized (Sendzimir process) (DIN EN 10346)

Product	H	B	t	G
BKB 110-10S	110 mm	100 mm	2,00 mm	1,89 kg
incl.: 4x KLR clamp fastening set				
BKB 110-15S	110 mm	150 mm	2,00 mm	2,36 kg
incl.: 4x KLR clamp fastening set				
BKB 110-20S	110 mm	200 mm	2,00 mm	2,78 kg
incl.: 4x KLR clamp fastening set				
BKB 110-30S	110 mm	300 mm	2,00 mm	3,92 kg
incl.: 4x KLR clamp fastening set				
BKB 110-40S	110 mm	400 mm	2,00 mm	5,34 kg
incl.: 4x KLR clamp fastening set				
BKB 110-50S	110 mm	500 mm	2,00 mm	7,00 kg
incl.: 4x KLR clamp fastening set				
BKB 110-60S	110 mm	600 mm	2,00 mm	8,93 kg
incl.: 4x KLR clamp fastening set				



H: height
B: width
t: material thickness
G: weight

DETAILS / APPLICATIONS

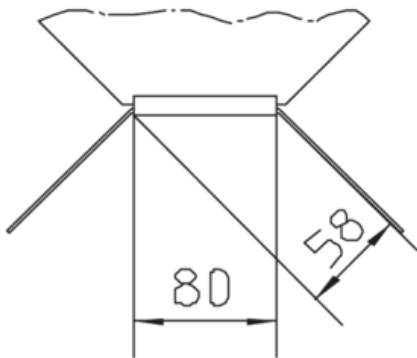

OPTIONAL ACCESSORIES

BKBDR, BKBDR-RHP, BKBDR-WZB AL, BKRTV 110, BKDS 110

