

## BKB 100

floor duct bend, height = 100 mm

floor duct bend 90° for horizontal change of direction with integrated connectors

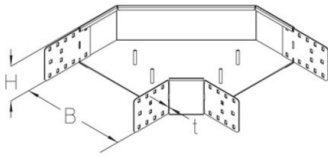

From a width  $\geq 300$  mm, one separating strip must be installed. From a width of  $\geq 500$  mm, two separating strips must be installed.



Continuously hot galvanized (Sendzimir process) (DIN EN 10346)

Product	H	B	t	G
BKB 100-10S	100 mm	100 mm	2,00 mm	1,84 kg
incl.: 4x KLR clamp fastening set				
BKB 100-15S	100 mm	150 mm	2,00 mm	2,30 kg
incl.: 4x KLR clamp fastening set				
BKB 100-20S	100 mm	200 mm	2,00 mm	2,71 kg
incl.: 4x KLR clamp fastening set				
BKB 100-30S	100 mm	300 mm	2,00 mm	3,82 kg
incl.: 4x KLR clamp fastening set				
BKB 100-40S	100 mm	400 mm	2,00 mm	5,21 kg
incl.: 4x KLR clamp fastening set				
BKB 100-50S	100 mm	500 mm	2,00 mm	6,83 kg
incl.: 4x KLR clamp fastening set				
BKB 100-60S	100 mm	600 mm	2,00 mm	8,74 kg
incl.: 4x KLR clamp fastening set				



**H:** height  
**B:** width  
**t:** material thickness  
**G:** weight

## DETAILS / APPLICATIONS

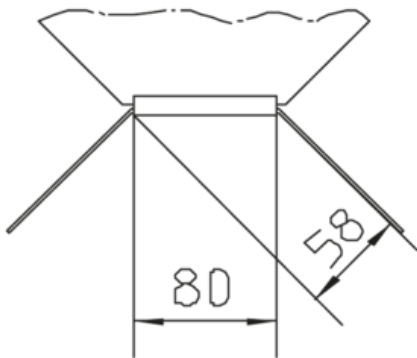

## OPTIONAL ACCESSORIES

BKBDR, BKBDR-RHP, BKBDR-WZB AL, BKRTV 100, BKDS 100



UL classified

