

BKAA 110

floor duct attachment branch, height = 110 mm

From a width \geq 300 mm, one separating strip must be installed. From a width of \geq 500 mm, two separating strips must be installed.

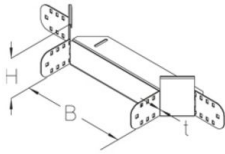

Continuously hot galvanized (Sendzimir process) (DIN EN 10346)

Product	H	B	t	G
BKAA 110-10S	110 mm	100 mm	2,00 mm	1,35 kg
incl.: 4x KLR	clamp fastening set			
BKAA 110-15S	110 mm	150 mm	2,00 mm	1,49 kg
incl.: 4x KLR	clamp fastening set			
BKAA 110-20S	110 mm	200 mm	2,00 mm	1,57 kg
incl.: 4x KLR	clamp fastening set			
BKAA 110-30S	110 mm	300 mm	2,00 mm	1,79 kg
incl.: 4x KLR	clamp fastening set			
BKAA 110-40S	110 mm	400 mm	2,00 mm	2,00 kg
incl.: 4x KLR	clamp fastening set			
BKAA 110-50S	110 mm	500 mm	2,00 mm	2,22 kg
incl.: 4x KLR	clamp fastening set			
BKAA 110-60S	110 mm	600 mm	2,00 mm	2,43 kg
incl.: 4x KLR	clamp fastening set			



H: height
B: width
t: material thickness
G: weight

DETAILS / APPLICATIONS

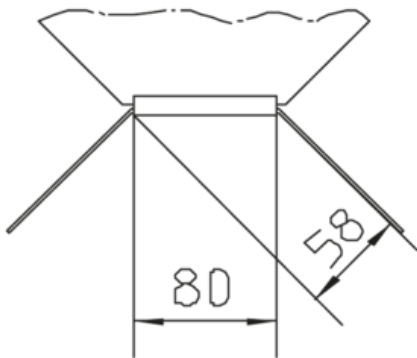

OPTIONAL ACCESSORIES

BKAADR, BKAADR-RHP, BKAADR-WZB AL, BKRTV 110, BKDS 110

