

BKAA 100

floor duct attachment branch, height = 100 mm

From a width \geq 300 mm, one separating strip must be installed. From a width of \geq 500 mm, two separating strips must be installed.

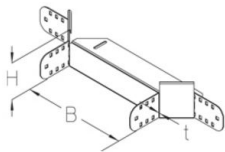

Continuously hot galvanized (Sendzimir process) (DIN EN 10346)

Product	H	B	t	G
BKAA 100-10S	100 mm	100 mm	2,00 mm	1,31 kg
incl.: 4x KLR	clamp fastening set			
BKAA 100-15S	100 mm	150 mm	2,00 mm	1,46 kg
incl.: 4x KLR	clamp fastening set			
BKAA 100-20S	100 mm	200 mm	2,00 mm	1,54 kg
incl.: 4x KLR	clamp fastening set			
BKAA 100-30S	100 mm	300 mm	2,00 mm	1,76 kg
incl.: 4x KLR	clamp fastening set			
BKAA 100-40S	100 mm	400 mm	2,00 mm	1,97 kg
incl.: 4x KLR	clamp fastening set			
BKAA 100-50S	100 mm	500 mm	2,00 mm	2,19 kg
incl.: 4x KLR	clamp fastening set			
BKAA 100-60S	100 mm	600 mm	2,00 mm	2,41 kg
incl.: 4x KLR	clamp fastening set			



H: height
B: width
t: material thickness
G: weight

DETAILS / APPLICATIONS

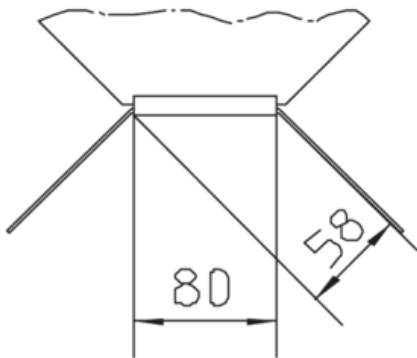

OPTIONAL ACCESSORIES

BKAADR, BKAADR-RHP, BKAADR-WZB AL, BKRTV 100, BKDS 100



UL classified

