

# BKA 100

floor duct branch, height = 100 mm

floor duct branch as T-piece with integrated connectors

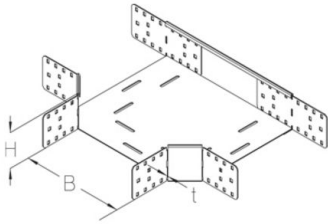

From a width  $\geq$  300 mm, one separating strip must be installed. From a width of  $\geq$  500 mm, two separating strips must be installed.



Continuously hot galvanized (Sendzimir process) (DIN EN 10346)

Product	H	B	t	G
BKA 100-10S	100 mm	100 mm	2,00 mm	2,94 kg
incl.: 6x KLR clamp fastening set				
BKA 100-15S	100 mm	200 mm	2,00 mm	3,33 kg
incl.: 6x KLR clamp fastening set				
BKA 100-20S	100 mm	200 mm	2,00 mm	3,83 kg
incl.: 6x KLR clamp fastening set				
BKA 100-30S	100 mm	300 mm	2,00 mm	5,07 kg
incl.: 6x KLR clamp fastening set				
BKA 100-40S	100 mm	400 mm	2,00 mm	6,66 kg
incl.: 6x KLR clamp fastening set				
BKA 100-50S	100 mm	500 mm	2,00 mm	8,51 kg
incl.: 6x KLR clamp fastening set				
BKA 100-60S	100 mm	600 mm	2,00 mm	10,72 kg
incl.: 6x KLR clamp fastening set				



**H:** height  
**B:** width  
**t:** material thickness  
**G:** weight

## DETAILS / APPLICATIONS

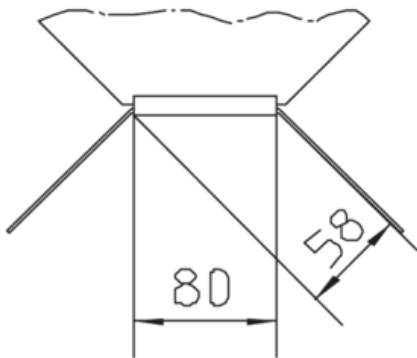

## OPTIONAL ACCESSORIES

BKADR, BKADR-RHP, BKADR-WZB AL, BKRTV 100, BKDS 100



UL classified

