

UVS

Captive washer

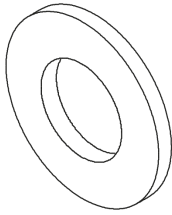

The captive washer UVS facilitates the pre-assembly of screws. The UVS is pushed onto the screw thread and becomes wedged on the screw thread. The screw is thus pre-assembled and captive. The UVS is made of polyamide and is available for thread sizes M6, M8 and M10.

polyethylen

Products	ø	D	t	W
UVS M6	6 mm	12,5 mm	1,30 mm	0,000 kg
UVS M8	8 mm	16,2 mm	1,65 mm	0,000 kg
UVS M10	10,5 mm	30 mm	2,10 mm	0,000 kg
UVS M10X24	10 mm	24 mm	2,10 mm	0,001 kg

Ø: inner diameter

D: diameter

t: material thickness

W: Weight per storage unit

DETAIL AND APPLICATION IMAGES



PRODUCT INFORMATION

