

UKEF160 V

Stainless steel hinged cover compact single outlet, 4-way, angular, flat

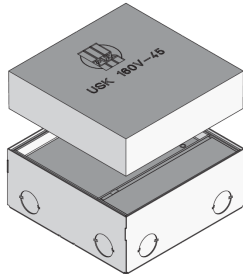

UKEF160 V are hinged cover compact single outlets consisting of a floor socket, a height-adjustable single outlet and a formwork body. The square components are inserted directly into the screed and are used to accommodate up to two installation devices. In addition, M25 pipes can be routed through the perforated side walls of the floor socket. The single outlets are made of stainless steel (V2A) and are suitable for use in dry-cleaned and damp-cleaned rooms with office traffic loads. They are available with installation dimensions of 166 x 166 mm.



Products	H _{min}	N	E	P _{max}	IP _g	IP _n	weight
UKEF160 15-V E	70 mm	20 mm	166 x 166 mm	2,00 kN	IP-20	IP-30	2,042 kg

H_{min}: minimum installation height
N: levelling range
E: fitting dimension
P_{max}: maximum load
IP_g: IP protection level in used condition
IP_n: IP protection level in unused condition

DETAIL AND APPLICATION IMAGES

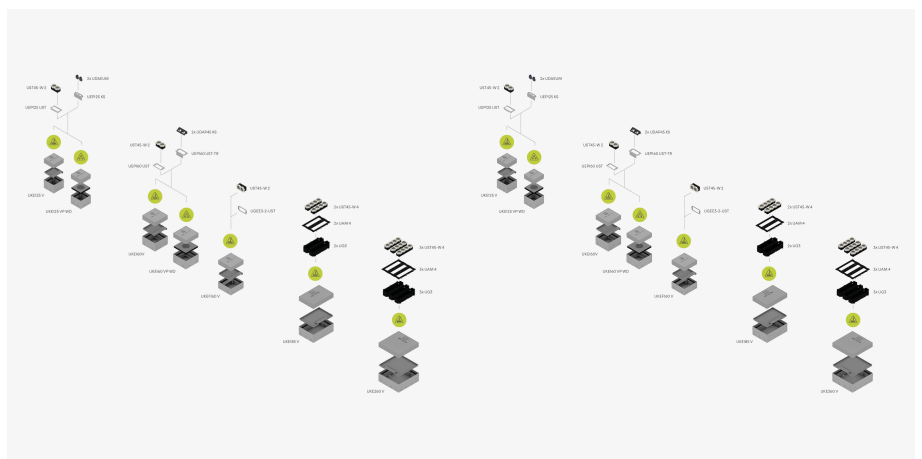
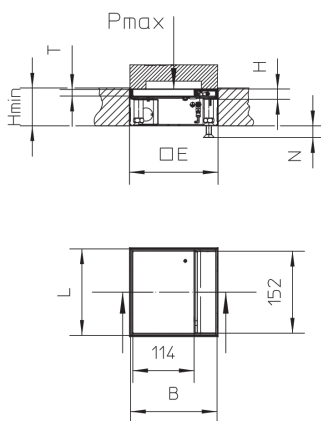

Page 1



OPTIONAL ACCESSORIES

UKENP 160



dry maintained



moistly maintained



Load requirements according to, DIN EN 50085

