

UEKD VP E

Stainless steel hinged cover unit, 3x, angular, flat

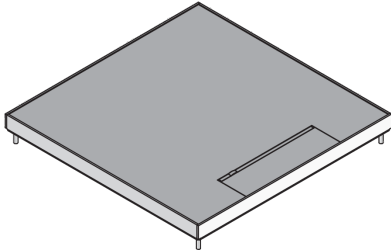

UEKD VP E components are square hinged cover units. They consist of a cartridge mounting frame with insert cartridge, cable outlet, floor-level cable outlet and rubber seal. Mounted on levelling units with Phillips screws, they accommodate max. 3 mounting boxes with installation devices and are used in floor sockets in dry-cleaned and damp-cleaned rooms with office traffic loads. The units are made of stainless steel with flat surfaces and slip resistance class R9. They have an IP protection class of IP 30 in an unused condition, an IP protection class of IP 20 when used and a max. load capacity of 4 kN. They have installation dimensions of 261 x 261 mm and a minimum installation height of 85 mm.



Stainless steel, according to ASTM 304 / BS 304 S 3

Products	H	H _{min}	B	L	E	P _{max}	IP _g	IP _n	T	mounting box	W
UEKD 15-VP E	19 mm	85 mm	258 mm	258 mm	261 x 261 mm	4,00 kN	IP-20	IP-30	0 mm	3	3,381 kg
incl.:											
1 x UGD-V 2, 1 x UKS M4X16E											

H: height

H_{min}: minimum installation height

B: width

L: length

E: fitting dimension

P_{max}: maximum load

IP_g: IP protection level in used condition

IP_n: IP protection level in unused condition

T: Depth of flooring recess

mounting box: maximum number of installable device casings

W: Weight per storage unit

DETAIL AND APPLICATION IMAGES



PRODUCT INFORMATION

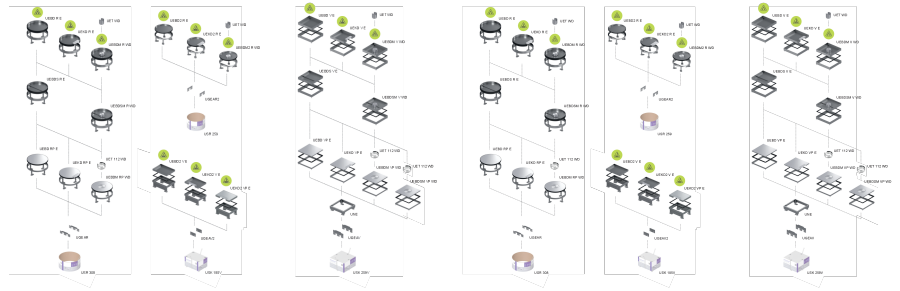
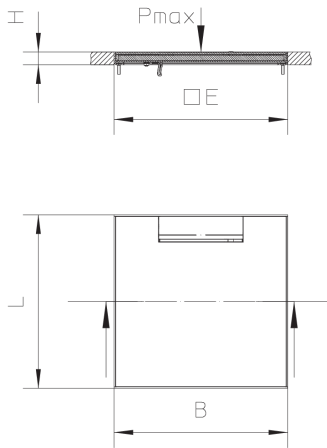

OPTIONAL ACCESSORIES

UNE



dry maintained



moistly maintained



Load requirements according to, DIN EN 50085

