

UEBDM V WD

Stainless steel tube cover unit, 3x, angular

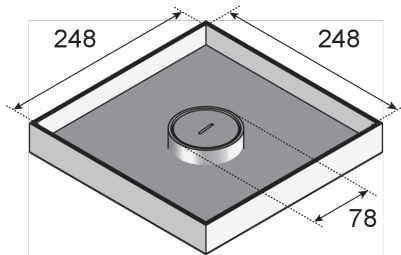

UEBDM V WD components are square tube cover units. They consist of a cartridge mounting frame with tube outlet, bolted tube mounting kit and rubber seal and are mounted using Phillips screws in floor sockets, assembly covers and raised or false floor openings in wet-cleaned rooms with office traffic loads. They can accommodate a maximum of 3 mounting boxes equipped with installation devices. The units are made of aluminium with an IP protection rating of IP 54 in an unused condition, an IP protection rating of IP 22 when used and a max. load of 2 kN. They are available with installation dimensions of 261 x 261 mm.



brass

Products	H	H _{min}	B	E	P _{max}	IP _g	IP _n	T	mounting box	W
UEBDM 25-V-WD MS	29 mm	95 mm	258 mm	261 x 261 mm	2,00 kN	IP-22	IP-54	16,5 mm	3	5,324 kg
incl.: 1 x UGD3-V 2, 4 x UKS M4X16E, 1 x UETD-R-WD										
UEBDM 35-V-WD MS	39 mm	105 mm	258 mm	261 x 261 mm	2,00 kN	IP-22	IP-54	26,5 mm	3	5,847 kg
incl.: 1 x UGD3-V 2, 4 x UKS M4X16E, 1 x UETD-R-WD										

Stainless steel, according to ASTM 304 / BS 304 S 3

Products	H	H _{min}	B	E	P _{max}	IP _g	IP _n	T	mounting box	W
UEBDM 15-V-WD	19 mm	85 mm	258 mm	261 x 261 mm	2,00 kN	IP-22	IP-54	12,5 mm	3	1,790 kg
incl.: 1 x UGD3-V 2, 4 x UKS M4X16E, 1 x UETD-R-WD										



PRODUCT INFORMATION

Products	H	H _{min}	B	E	P _{max}	IP _g	IP _n	T	mounting box	W
UEBDM 25-V-WD	29 mm	95 mm	258 mm	261 x 261 mm	2,00 kN	IP-22	IP-54	22,5 mm	3	2,156 kg
incl.: 1 x UGD3-V 2, 4 x UKS M4X16E, 1 x UETD-R-WD										
UEBDM 35-V-WD	39 mm	105 mm	258 mm	261 x 261 mm	2,00 kN	IP-22	IP-54	32,5 mm	3	2,520 kg
incl.: 1 x UGD3-V 2, 4 x UKS M4X16E, 1 x UETD-R-WD										
UEBDM 45-V-WD	49 mm	115 mm	258 mm	261 x 261 mm	2,00 kN	IP-22	IP-54	42,5 mm	3	2,654 kg
incl.: 1 x UGD3-V 2, 4 x UKS M4X16E, 1 x UETD-R-WD										

H: height

H_{min}: minimum installation height

B: width

E: fitting dimension

P_{max}: maximum load

IP_g: IP protection level in used condition

IP_n: IP protection level in unused condition

T: Depth of flooring recess

mounting box: maximum number of installable device casings

W: Weight per storage unit

DETAIL AND APPLICATION IMAGES



PRODUCT INFORMATION

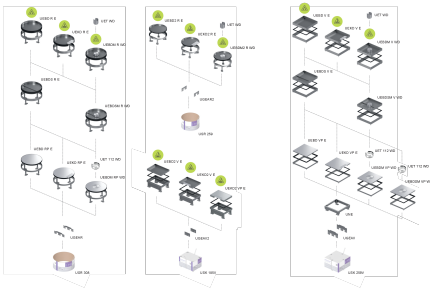
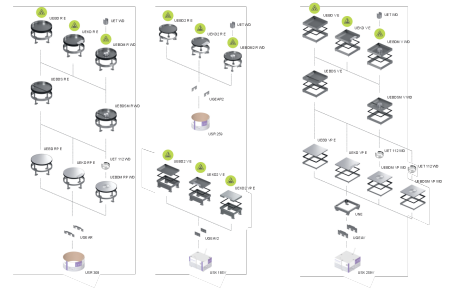
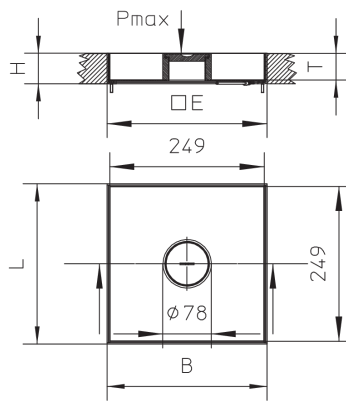
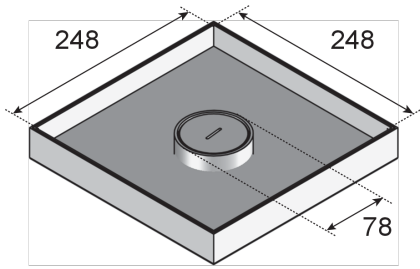

OPTIONAL ACCESSORIES

UEBDME V, UET WD, UNE



wet maintained



Load requirements according to, DIN EN 50085

