

## UEBD RP E

Stainless steel dummy cover unit, 3x, round, flat

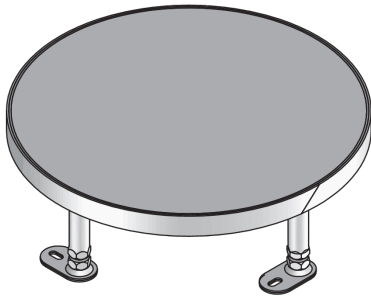

UEBD RP E installation units are round dummy cover units with abutting edges. They can accommodate a maximum of three mounting boxes. They consist of height-adjustable mounting frames with a dummy insert cartridge and a rubber seal and are suitable for wet-cleaned rooms with office traffic loads. They are installed in assembly covers, floor sockets and raised or false floor openings. The components are made of stainless steel V2A and have a flat, blasted surface with the slip resistance class R9. They have an IP protection class of IP 54 in an unused condition, a max. load capacity of 4 kN, a levelling range of 55 mm and installation dimensions of 307 mm.



Stainless steel, according to ASTM 304 / BS 304 S 3

Products	H	H <sub>min</sub>	N	E	P <sub>max</sub>	IP <sub>n</sub>	T	mounting box	W
UEBD 15-RP E	21 mm	100 mm	55 mm	307 mm	4,00 kN	IP-54	0 mm	3	5,500 kg
incl.:									
1 × UGEAR-ELS, 1 × UGD-R 10-2, 1 × UGDB15-R300 1.8									

**H:** height

**H<sub>min</sub>:** minimum installation height

**N:** levelling range

**E:** fitting dimension

**P<sub>max</sub>:** maximum load

**IP<sub>n</sub>:** IP protection level in unused condition

**T:** Depth of flooring recess

**mounting box:** maximum number of installable device casings

**W:** Weight per storage unit

## DETAIL AND APPLICATION IMAGES



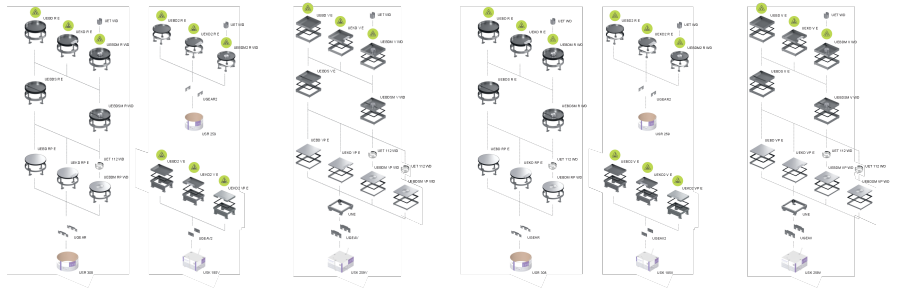
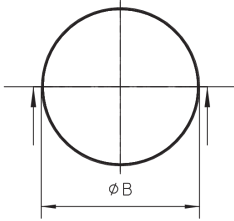
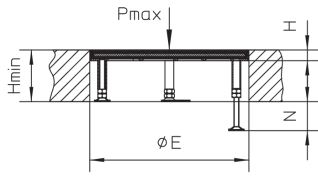

## OPTIONAL ACCESSORIES

UBDSLFL, UGM SLF



wet maintained



Load requirements according to, DIN EN 50085

