

UBEBMBI

Inside bend

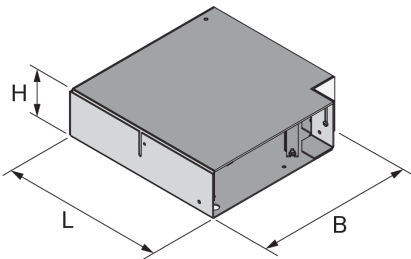

The range of screed-flush brush ducts also includes inside bends UBEBMBI. These products are used as connectors between two duct sections. Their angular shape allows cables to even be laid even at an internal angle of 90 degrees. These components are made of sendzimir hot-dip galvanised sheet steel in accordance with DIN EN 10346 and are 295 mm across.

steel, continously hot galvanized/Sendzimir process

Products	H	N	B	L	W
UBEBMBI 85-25S	85 mm	0-25 mm	295 mm	295 mm	5,439 kg

H: height
N: levelling range
B: width
L: length
W: Weight per storage unit

DETAIL AND APPLICATION IMAGES

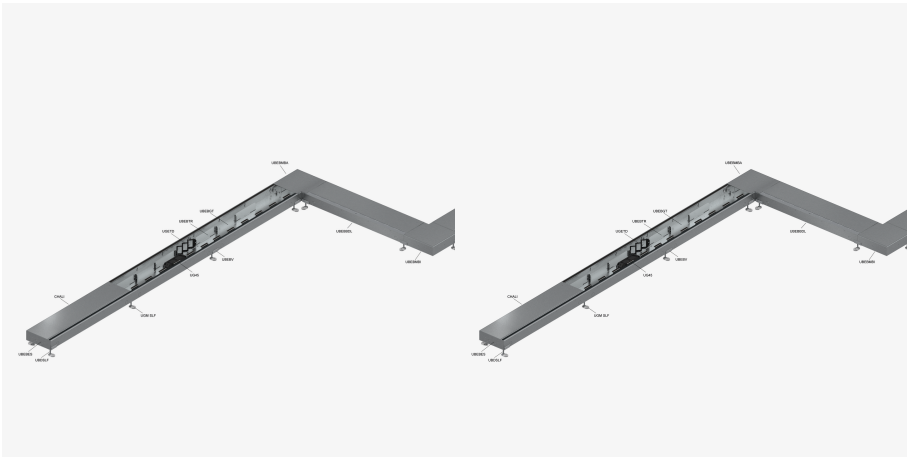
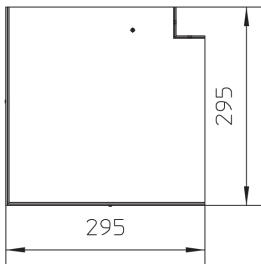

PRODUCT INFORMATION

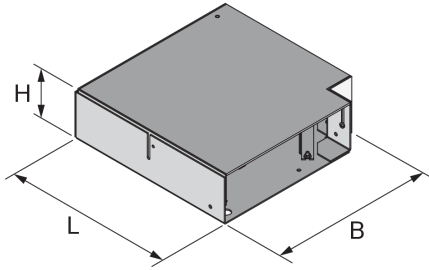

OPTIONAL ACCESSORIES

CHALI

DIN

Load requirements according to, DIN EN 50085

