

UBDHB250 3V

False floor socket, 3x, angular

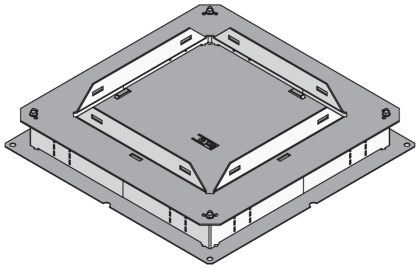

The UBDHB250 3V components are false floor sockets that are installed as pull boxes and built-in boxes on screed-covered underfloor ducts. They have a mounting hole to accommodate a formwork body, which is replaced by a square plastic or stainless steel installation unit during final assembly. The supplied earthing clamps are used for equipotential bonding. The floor sockets with side walls that can be bent open on all sides are made of sendzimir hot-dip galvanised sheet steel in accordance with DIN EN 10346 and have VDE/TÜV approval in accordance with DIN EN 50085.



Products	H	H _{min}	B1	B2	L1	L2	E	mounting box	W
UBDHB250 28-259V	31 mm	67 mm	385 mm	400 mm	385 mm	400 mm	262 x 262 mm	3	0 1 2,832 kg
incl.: 1 x UBDHB-Z									
UBDHB250 38-259V	41 mm	77 mm	385 mm	400 mm	385 mm	400 mm	262 x 262 mm	3	0 1 2,916 kg
incl.: 1 x UBDHB-Z									
UBDHB250 48-259V	51 mm	87 mm	385 mm	400 mm	385 mm	400 mm	262 x 262 mm	3	0 1 3,004 kg
incl.: 1 x UBDHB-Z									

H: height

H_{min}: minimum installation height

B1: width

B2: width

L1: length 1

L2: length 2

E: fitting dimension

mounting box: maximum number of installable device casings

W: Weight per storage unit



PRODUCT INFORMATION

DETAIL AND APPLICATION IMAGES

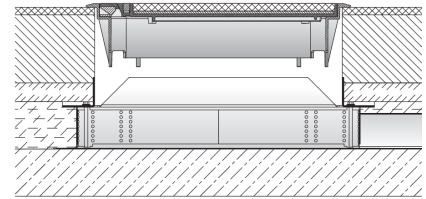
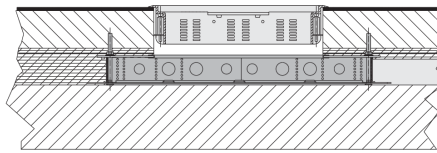
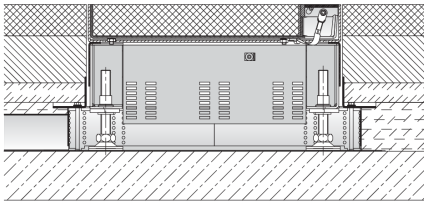
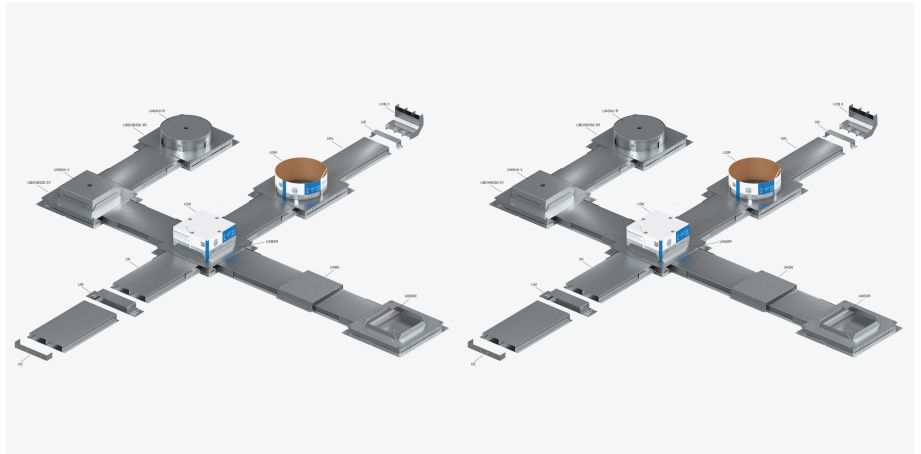
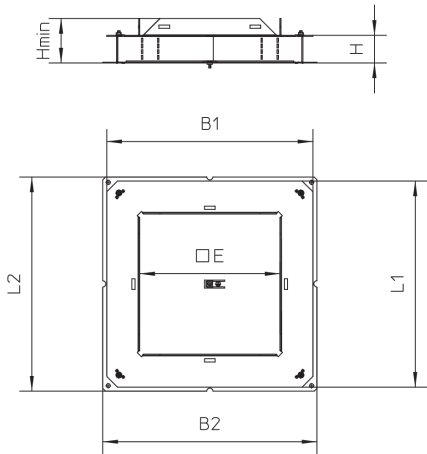

OPTIONAL ACCESSORIES

USK, UN



Load requirements according to, DIN EN 50085

