

SRK-O

End sleeve as edge protection

The end sleeve SRK-O is fitted on the protective tube to protect the edge and prevent accidents in line with DIN 4118. It is available in diameters of 30 or 60 mm and is made from polyvinyl chloride.

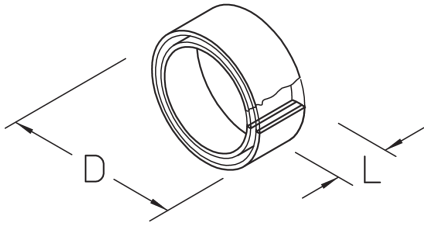

Polyvinyl chloride

Products	L	D	t	weight
SRK-O 30	25 mm	30 mm	2,00 mm	0,010 kg
SRK-O 60	25 mm	60 mm	2,00 mm	0,020 kg

L: length
D: diameter
t: material thickness

DETAIL AND APPLICATION IMAGES

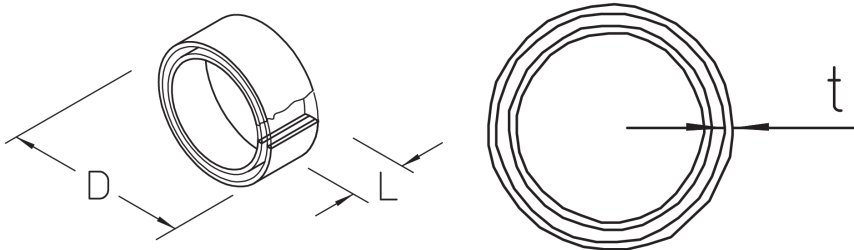

OPTIONAL ACCESSORIES

SR, SRL

