

## SKL M

### Beam clamp set

The beam clamp set SKL M can be combined with mounting channel KHA 2. It is used to fix KDU 60 bracket supports to steel beams. The set can be loaded up to 10 kN. The clamping range extends from 5 - 25 mm. We provide components in various materials and surface finishes to ensure that various corrosion protection requirements for different areas of application are met.

steel, batch/hot-dip galvanized

Products	k	$P_{max}$	M	weight
SKL MF	5 - 25 mm	10,00 kN	35 Nm	0,477 kg
incl.:				
2 × SES 10X55F, 2 × US 10X21F, 2 × US 10X30F, 2 × SEM 10F, 2 × UVS M10X24				

Stainless steel, according to ASTM 316 Ti / AISI 316 L, BS 320S17 / BS 316S11

Products	k	$P_{max}$	M	weight
SKL ME4	5 - 25 mm	10,00 kN	35 Nm	0,458 kg
incl.:				
2 × US 10X30E4, 2 × US 10X21E4, 2 × UVS M10X24, 2 × SES 10X55E4, 2 × SEM 10E4				

**k:** clamping range  
 **$P_{max}$ :** maximum load  
**M:** torque

## DETAIL AND APPLICATION IMAGES



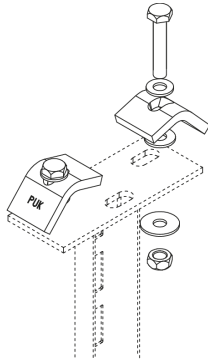

## OPTIONAL ACCESSORIES

KDU 60, KHA 2, HS22

