

SA Anchor bolt

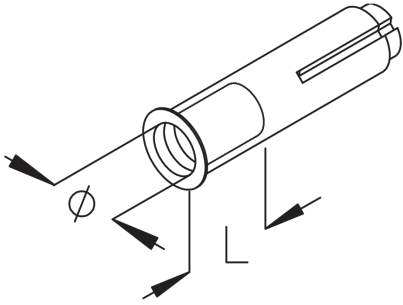

The approved anchor bolt SA is used to fasten supporting structures such as bracket holders or wall brackets to walls and/or ceilings. It is permitted to be used as a multiple fastener in non-cracked standard concrete with strength \geq C20/25. The manufacturer's specifications must be observed. The anchor bolt is available in diameters 8 to 15 mm. The permissible tensile force is up to 8.5 kN. We provide components in various materials and surface finishes to ensure that various corrosion protection requirements for different areas of application are met.

steel, galvanic zinc plated

Products	\varnothing	D	L_{\min}	P_{Zug}	weight
SA 6	6 mm	8 mm	27 mm	3,95 kN	0,008 kg
SA 8	8 mm	10 mm	33 mm	3,95 kN	0,011 kg
SA 10	10 mm	12 mm	44 mm	6,1 kN	0,022 kg
SA 12	12 mm	15 mm	54 mm	8,5 kN	0,041 kg

Stainless steel, according to ASTM 316 Ti / AISI 316 L, BS 320S17 / BS 316S11

Products	\varnothing	D	L_{\min}	P_{Zug}	weight
SA 6E4	6 mm	8 mm	27 mm	3,95 kN	0,006 kg
SA 8E4	8 mm	10 mm	33 mm	3,95 kN	0,012 kg
SA 10E4	10 mm	12 mm	44 mm	6,1 kN	0,024 kg
SA 12E4	12 mm	15 mm	54 mm	8,5 kN	0,015 kg

\varnothing : thread diameter

D: diameter

L_{\min} : min. borehole depth

P_{Zug} : max. permissible tensile force



DETAIL AND APPLICATION IMAGES

