

RAED

Cable tray attachment corner cover

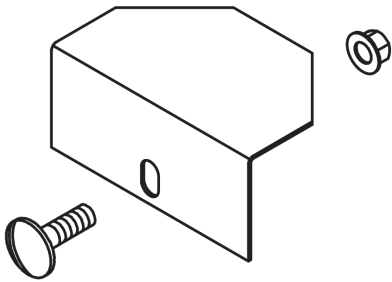

The cable tray attachment corner cover RAED with captive washer, round-head bolt and nut with flange is mounted on the RAE cable tray attachment corner and protects it from dirt and moisture. We provide components in various materials and surface finishes to ensure that the corrosion requirements are met for all sorts of applications.

steel, continuously hot galvanized/Sendzimir process

Products	W
RAED S	0,060 kg
incl.:	
1 x UVS M6, 1 x FRSV 6X12, 1 x SEMS 6	

steel, batch/hot-dip galvanized

Products	W
RAED F	0,066 kg
incl.:	
1 x FRSV 6X12E, 1 x SEMS 6E, 1 x UVS M6	

Stainless steel, according to ASTM 304 / BS 304 S 3

Products	W
RAED E	0,062 kg
incl.:	
1 x FRSV 6X12E, 1 x SEMS 6E, 1 x UVS M6	



PRODUCT INFORMATION

W: Weight per storage unit

DETAIL AND APPLICATION IMAGES

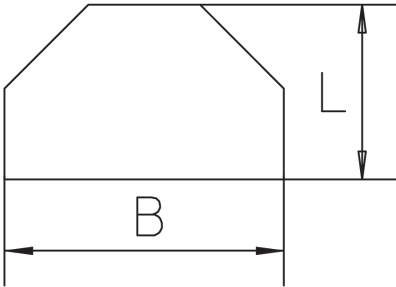

OPTIONAL ACCESSORIES

RD-SW

