

## KSL-SP

### Spacer

The KSL-SP spacer must be installed for wall brackets, bracket holders and ceiling brackets of the W profile system to prevent deformation of the profile due to the preload force of the fastening element. We provide components in various materials and surface finishes to ensure that the corrosion requirements are met for all sorts of applications.

steel, continuously hot galvanized/Sendzimir process

Products	H	B	L	weight
KSL-SP S	17 mm	18 mm	35 mm	0,030 kg

steel, batch/hot-dip galvanized

Products	H	B	L	weight
KSL-SP F	17 mm	18 mm	35 mm	0,030 kg

**H:** height  
**B:** width  
**L:** length

## DETAIL AND APPLICATION IMAGES



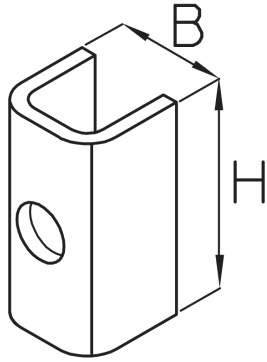

## OPTIONAL ACCESSORIES

KSLW, KDSL, DKSL

