

## KNK-NG

Junction chain link

Replacement link for chain KNK. After installation/assembly, the emergency link must be pressed together using pliers.

steel, galvanic zinc plated

Products	t	weight
KNK-NG	3,00 mm	0,003 kg

t: material thickness

## DETAIL AND APPLICATION IMAGES

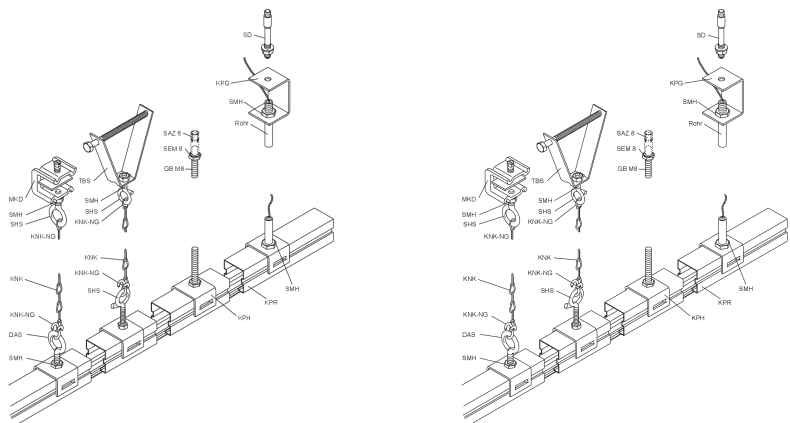
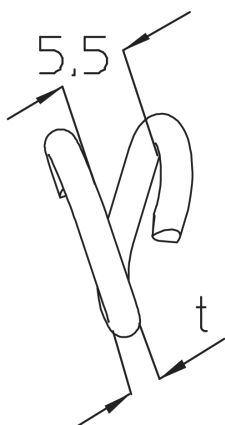

## OPTIONAL ACCESSORIES

KNK, DAS, SHS, SHH, DSAGCB, DSAGRIPADAP, DSATIGERCLIP





PohlCon GmbH  
Nobelstraße 51 | 12057 Berlin  
Telefon: +49 30 68283-04 | Fax: +49 30 68283-383 | [contact@pohlcon.com](mailto:contact@pohlcon.com)

