

KHA 9

40x25 mm profile rail, perforated

The profile rail KHA 9 consists of a C+ profile 39.5 x 25 mm with continuous perforation and a slot width of 18 mm (material thickness = 2.75 mm). It is made of hot-dip galvanized steel and is available in lengths of 200 or 6000 mm.

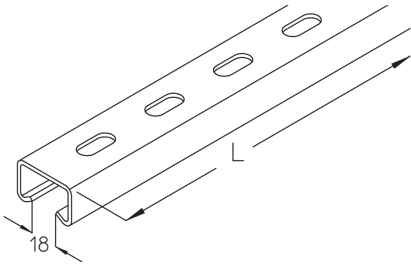

steel, batch/hot-dip galvanized

Products	L	H _p	B _p	t	W
KHA 9-02F	200 mm	25 mm	39,5 mm	2,75 mm	0,370 kg
KHA 9-03F	300 mm	25 mm	39,5 mm	2,75 mm	0,550 kg
KHA 9-04F	400 mm	25 mm	39,5 mm	2,75 mm	0,730 kg
KHA 9-05F	500 mm	25 mm	39,5 mm	2,75 mm	0,910 kg
KHA 9-06F	600 mm	25 mm	39,5 mm	2,75 mm	1,100 kg
KHA 9-07F	700 mm	25 mm	39,5 mm	2,75 mm	1,280 kg
KHA 9-08F	800 mm	25 mm	39,5 mm	2,75 mm	1,460 kg
KHA 9-09F	900 mm	25 mm	39,5 mm	2,75 mm	1,640 kg
KHA 9-10F	1000 mm	25 mm	39,5 mm	2,75 mm	1,820 kg
KHA 9-11F	1100 mm	25 mm	39,5 mm	2,75 mm	2,000 kg
KHA 9-12F	1200 mm	25 mm	39,5 mm	2,75 mm	2,190 kg
KHA 9-13F	1300 mm	25 mm	39,5 mm	2,75 mm	2,370 kg
KHA 9-14F	1400 mm	25 mm	39,5 mm	2,75 mm	2,550 kg
KHA 9-15F	1500 mm	25 mm	39,5 mm	2,75 mm	2,730 kg
KHA 9-20F	2000 mm	25 mm	39,5 mm	2,75 mm	3,640 kg
KHA 9-30F	3000 mm	25 mm	39,5 mm	2,75 mm	5,460 kg
KHA 9-60F	6000 mm	25 mm	39,5 mm	2,75 mm	10,920 kg

L: length
H_p: profile height

Page 1



PRODUCT INFORMATION

B_p: profile width
t: material thickness
W: Weight per storage unit

DETAIL AND APPLICATION IMAGES

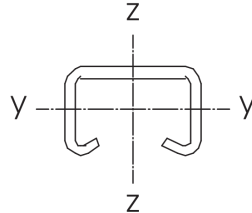
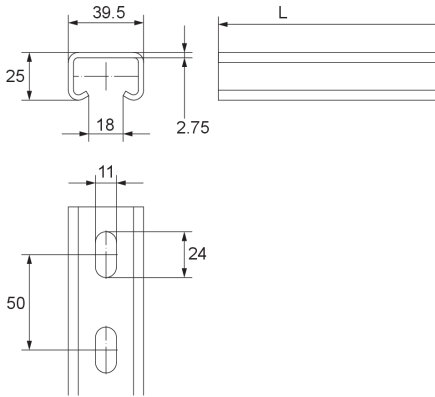

$$W_y = 1.25 \text{ cm}^3$$
$$W_z = 2.85 \text{ cm}^3$$
$$I_y = 1.70 \text{ cm}^4$$
$$I_z = 5.62 \text{ cm}^4$$

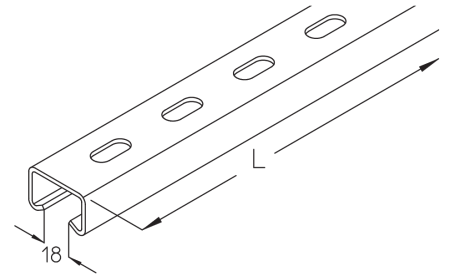

OPTIONAL ACCESSORIES

HS18, AMA 18, ASK 8

