

KHA 41

41x41 mm profile rail, perforated

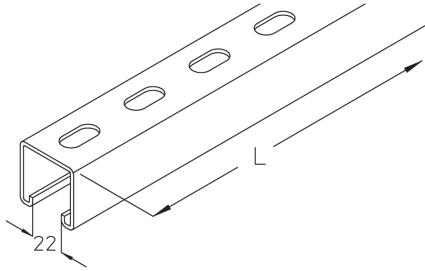

The mounting channel KHA 41 consists of a C+ profile 41 x 41 mm with continuous perforation and a slot width of 22 mm made from material 2.5 mm thick. It is made of hot-dip galvanised steel. KHA 41 also serves as a bracket holder in combination with head plate BGA 41 and is available in lengths of up to 6000 mm.

steel, batch/hot-dip galvanized

Products	L	H _p	B _p	t	weight
KHA 41-01F	100 mm	41 mm	41 mm	2,50 mm	0,260 kg
KHA 41-02F	200 mm	41 mm	41 mm	2,50 mm	0,500 kg
KHA 41-03F	300 mm	41 mm	41 mm	2,50 mm	0,700 kg
KHA 41-04F	400 mm	41 mm	41 mm	2,50 mm	1,000 kg
KHA 41-05F	500 mm	41 mm	41 mm	2,50 mm	1,300 kg
KHA 41-06F	600 mm	41 mm	41 mm	2,50 mm	1,600 kg
KHA 41-07F	700 mm	41 mm	41 mm	2,50 mm	1,800 kg
KHA 41-08F	800 mm	41 mm	41 mm	2,50 mm	2,100 kg
KHA 41-09F	900 mm	41 mm	41 mm	2,50 mm	2,400 kg
KHA 41-10F	1000 mm	41 mm	41 mm	2,50 mm	2,600 kg
KHA 41-11F	1100 mm	41 mm	41 mm	2,50 mm	2,900 kg
KHA 41-12F	1200 mm	41 mm	41 mm	2,50 mm	3,200 kg
KHA 41-13F	1300 mm	41 mm	41 mm	2,50 mm	3,400 kg
KHA 41-14F	1400 mm	41 mm	41 mm	2,50 mm	3,700 kg
KHA 41-15F	1500 mm	41 mm	41 mm	2,50 mm	4,000 kg
KHA 41-20F	2000 mm	41 mm	41 mm	2,50 mm	5,200 kg
KHA 41-30F	3000 mm	41 mm	41 mm	2,50 mm	7,800 kg
KHA 41-60F	6000 mm	41 mm	41 mm	2,50 mm	15,600 kg

L: length

Page 1



PRODUCT INFORMATION

H_p : profile height
 B_p : profile width
 t : material thickness

DETAIL AND APPLICATION IMAGES

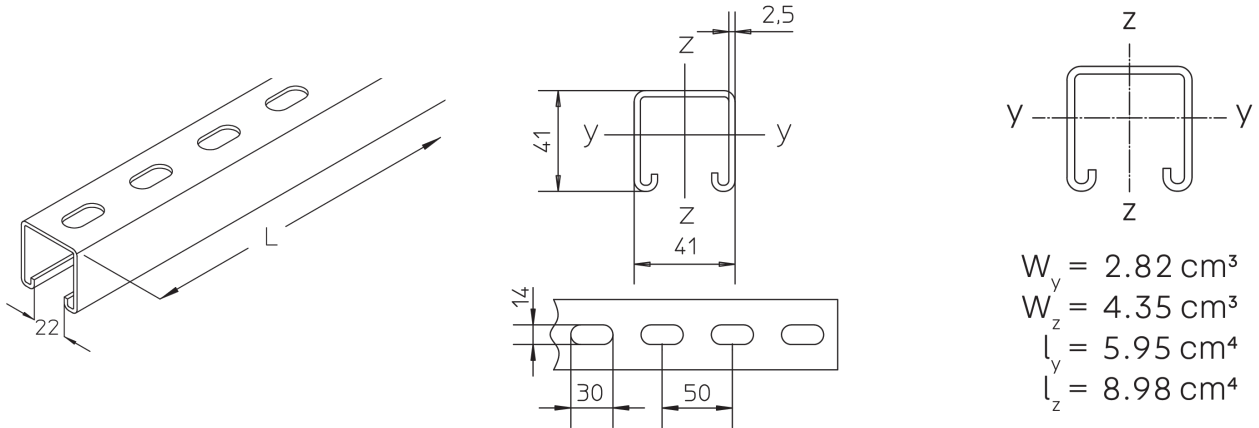

OPTIONAL ACCESSORIES

AKL, AM 22, AMF 22, BGA 41, BGA 41/2, RUS 41, SKS A, SA 2, SAI 41, KA 41, KA 30, AV, BL 5, AVL, AVE, AVA, AVB, AVLW, AVAW, RP

