

## KBSW

Bracket fixing for steel girders and walls

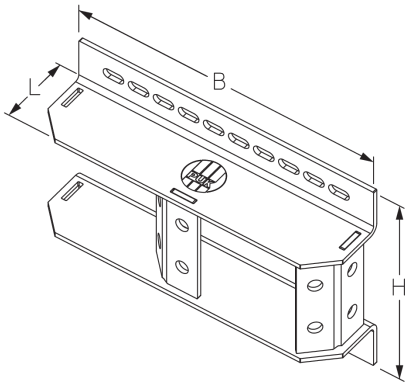

Bracket fixing (heavy) for dowelling or clamping for universal fixing with 0°, 45° or 90° bracket arrangement. Suitable for clamping range from 100 to 300 mm. 4 clamping points are required for clamp fixing.

The maximum bracket loads of the brackets to be used apply for 0°, 45°, 90° dowel fixing and 90° clamp fixing. When clamping at 0° and 45°, the friction ratios must be observed.

steel, batch/hot-dip galvanized

Products	H	B	L	t	weight
KBSW F	268 mm	400 mm	97 mm	6 mm	6,809 kg
KBSWS F	398 mm	400 mm	97 mm	6 mm	7,907 kg

**H:** height  
**B:** width  
**L:** length  
**t:** material thickness

## DETAIL AND APPLICATION IMAGES

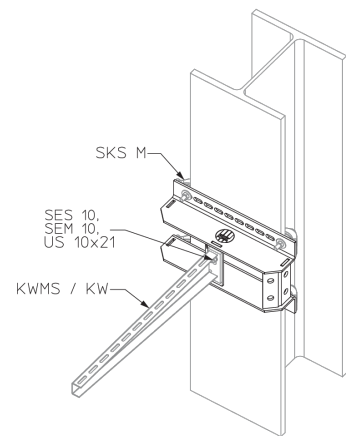
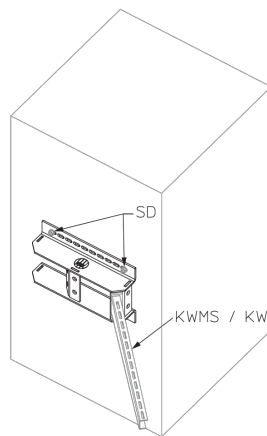
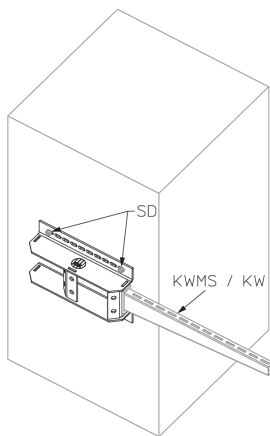

# PRODUCT INFORMATION

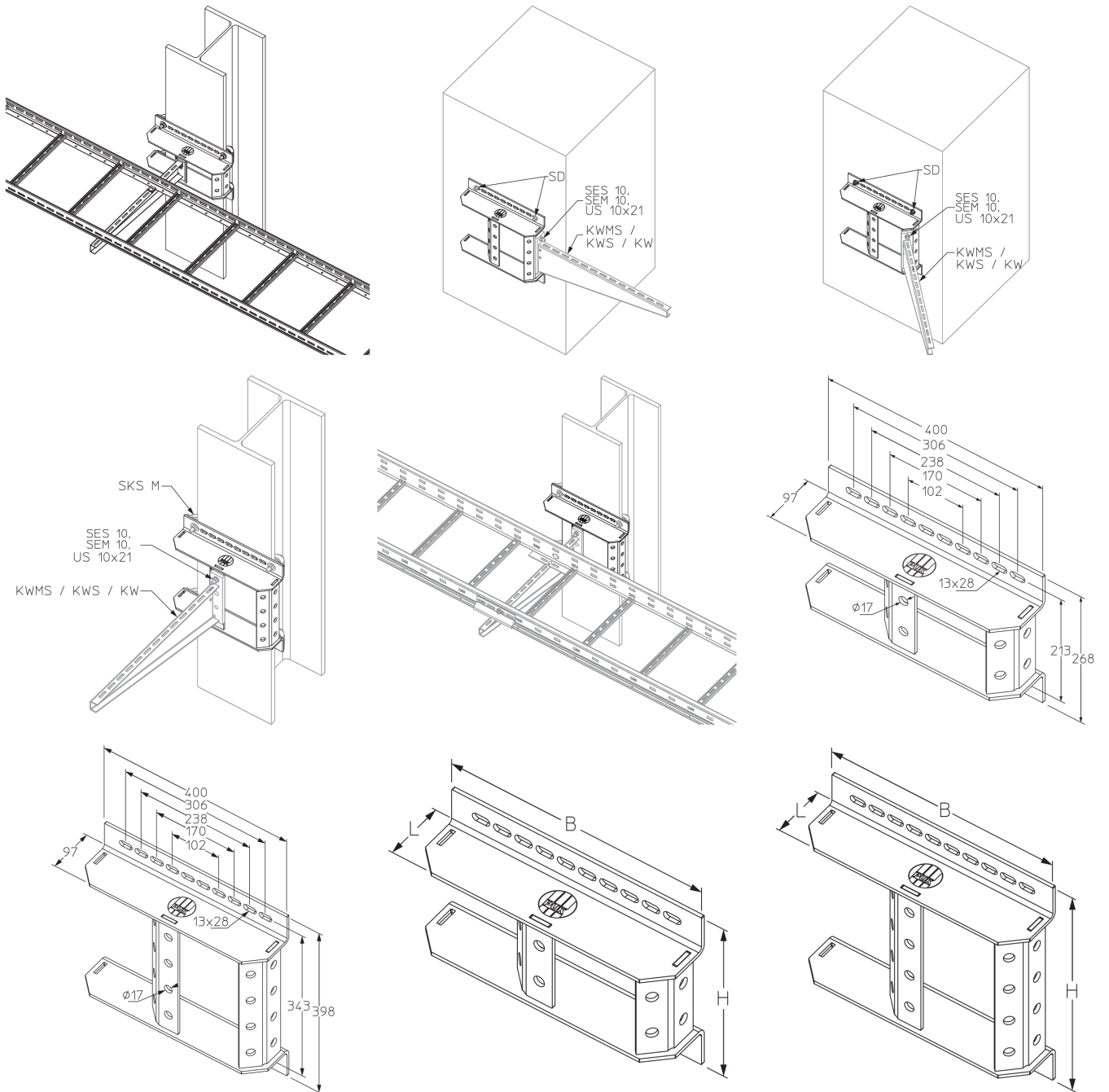

## OPTIONAL ACCESSORIES

SKS M, SD, KW, KWMS, KWS

