

JTA RF W 40/22

Anchor channel, hot-rolled, for fastening façades to ceiling end panels

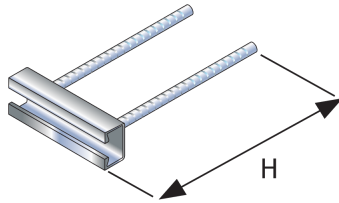

The anchor channel JTA RF W 40/22 is made of hot-dip galvanised steel (fv) or stainless steel (A4). The JTA RF W 40/22 has reinforcing bars as anchors made of reinforcing steel. It is available in profile lengths from 150 to 350 mm and in several variants for the concrete cover and is paired with the bolts JC M10 - JC M16. The filling is made of polyethylene (PE).

steel, batch/hot-dip galvanized

Products	H	B	L	W
JTARFW4022-0300-FVK	330 mm	40 mm	300 mm	0,726 kg

H: height
B: width
L: length
W: Weight per storage unit

DETAIL AND APPLICATION IMAGES

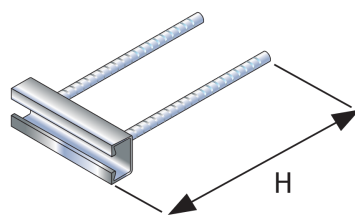

OPTIONAL ACCESSORIES

JGM C, JVL

Page 1





PohlCon GmbH
Nobelstraße 51 | 12057 Berlin
Telefon: +49 30 68283-04 | Fax: +49 30 68283-383 | contact@pohlcon.com

