

JGM B

Hook-head locking plate, threaded plate for spaced mounting

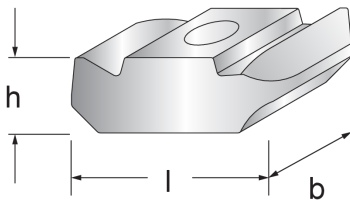

JGM B hook-head locking plates are threaded plates that are inserted at any point of the corresponding anchor or mounting channel. The threaded hole is centred by turning the nut 90° after inserting or tipping in the nut. Locking plates are used for spaced mounting with long bolts or threaded rods. When screwing in the threaded rod, the locking plates tilt and create an efficient connection without requiring additional locking. The JGM B hook-head locking plates are forged to an exact shape and therefore cannot turn back. They are available in galvanised steel or stainless steel (A4) and in various threads to fit numerous rails.

Products	H	B	L	weight
GGB10 A4	16 mm	21 mm	41 mm	0,087 kg
GGB10 GV	16 mm	21 mm	41 mm	0,086 kg
GGB12 A4	16 mm	21 mm	41 mm	0,082 kg
GGB12 GV	16 mm	21 mm	41 mm	0,088 kg
GGB16 A4	16 mm	26 mm	41 mm	0,090 kg
GGB16 GV	16 mm	26 mm	41 mm	0,085 kg
GGB6 A4	16 mm	21 mm	41 mm	0,081 kg
GGB6 GV	16 mm	21 mm	41 mm	0,091 kg
GGB8 A4	16 mm	21 mm	41 mm	0,083 kg
GGB8 GV	16 mm	21 mm	41 mm	0,088 kg

H: height
B: width
L: length

DETAIL AND APPLICATION IMAGES



PRODUCT INFORMATION

