

IK

Hexagon socket head screw, DIN 912

The hexagon socket head screw IK (in line with DIN 912) is suitable for numerous applications. It is available in lengths from 10 to 50 mm and with threads from M6 to M12. We provide components in various materials and surface finishes to ensure that various corrosion protection requirements for different areas of application are met.

steel, galvanic zinc plated

Products	ø	L	D	W
IK 5X10	5 mm	10 mm	8,3 mm	0,005 kg
IK 5X40	5 mm	40 mm	8,3 mm	0,019 kg
IK 6X20	6 mm	20 mm	10,2 mm	0,006 kg
IK 8X20	8 mm	20 mm	13,3 mm	0,012 kg
IK 8X25	8 mm	25 mm	13,3 mm	0,014 kg
IK 8X30	8 mm	30 mm	13,3 mm	0,015 kg
IK 8X40	8 mm	40 mm	13,3 mm	0,019 kg
IK 10X20	10 mm	20 mm	16,3 mm	0,021 kg
IK 10X25	10 mm	25 mm	16,3 mm	0,024 kg
IK 10X30	10 mm	30 mm	16,3 mm	0,026 kg
IK 10X40	10 mm	40 mm	16,3 mm	0,031 kg
IK 12X20	12 mm	20 mm	18,3 mm	0,031 kg
IK 12X25	12 mm	25 mm	18,3 mm	0,035 kg
IK 12X30	12 mm	30 mm	18,3 mm	0,038 kg
IK 12X40	12 mm	40 mm	18,3 mm	0,045 kg
IK 12X50	12 mm	50 mm	18,3 mm	0,052 kg

Stainless steel, according to ASTM 304 / BS 304 S 3



PRODUCT INFORMATION

Products	Ø	L	D	W
IK 8X10E	8 mm	10 mm	13,3 mm	0,009 kg
IK 8X20E	8 mm	20 mm	13,3 mm	0,012 kg
IK 8X25E	8 mm	25 mm	13,3 mm	0,014 kg
IK 8X30E	8 mm	30 mm	13,3 mm	0,015 kg
IK 8X40E	8 mm	40 mm	13,3 mm	0,019 kg
IK 8X50E	8 mm	50 mm	13,3 mm	0,024 kg
IK 10X20E	10 mm	20 mm	16,3 mm	0,021 kg
IK 10X25E	10 mm	25 mm	16,3 mm	0,024 kg
IK 10X30E	10 mm	30 mm	16,3 mm	0,026 kg
IK 10X40E	10 mm	40 mm	16,3 mm	0,032 kg
IK 12X20E	12 mm	20 mm	18,3 mm	0,032 kg
IK 12X25E	12 mm	25 mm	18,3 mm	0,035 kg
IK 12X30E	12 mm	30 mm	18,3 mm	0,039 kg
IK 12X40E	12 mm	40 mm	18,3 mm	0,046 kg
IK 12X50E	12 mm	50 mm	18,3 mm	0,054 kg

Ø: thread diameter
L: length
D: diameter
W: Weight per storage unit

DETAIL AND APPLICATION IMAGES

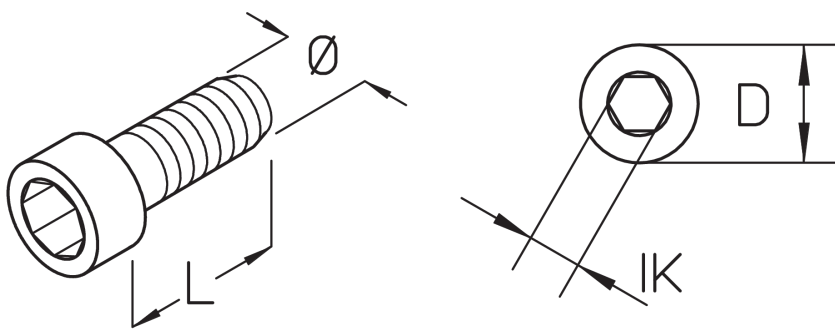



PohlCon GmbH
Nobelstraße 51 | 12057 Berlin
Telefon: +49 30 68283-04 | Fax: +49 30 68283-383 | contact@pohlcon.com

