

## GBAR

### Middle suspending bracket, external

The external central suspension GBAR is used for suspending cable trays up to 300 mm wide from ceilings. It is designed for loads of up to 0.7 kN. We provide components in various materials and surface finishes to ensure that the corrosion requirements are met for all sorts of applications. The GB threaded rod is 1000 mm long and is included in the set. FD/P: factor for calculating the dowel load FD with the actual bracket load P or the sum of the actual bracket loads.

### steel, continuously hot galvanized/Sendzimir process

Products	H	B	L	$P_{max}$	$F_D/P$	weight
GBAR 10S	1000 mm	30 mm	60 mm	0,70 kN	1,00	0,612 kg
incl.:						
1 × KLR, 1 × GB M10-10, 3 × SEM 10, 1 × US 10X30						
GBAR 20S	1000 mm	30 mm	160 mm	0,70 kN	1,00	0,742 kg
incl.:						
1 × GB M10-10, 3 × SEM 10, 1 × US 10X30, 1 × KLR						
GBAR 30S	1000 mm	30 mm	260 mm	0,70 kN	1,00	0,872 kg
incl.:						
1 × GB M10-10, 3 × SEM 10, 1 × US 10X30, 1 × KLR						

### Stainless steel, according to ASTM 304 / BS 304 S 3

Products	H	B	L	$P_{max}$	$F_D/P$	weight
GBAR 10E	1000 mm	30 mm	60 mm	0,70 kN	1,00	0,616 kg
incl.:						
1 × GB M10-10E, 3 × SEM 10E, 1 × US 10X30E, 1 × KLR E						
GBAR 20E	1000 mm	30 mm	160 mm	0,70 kN	1,00	0,746 kg
incl.:						
1 × KLR E, 1 × GB M10-10E, 3 × SEM 10E, 1 × US 10X30E						
GBAR 30E	1000 mm	30 mm	260 mm	0,70 kN	1,00	0,876 kg

Page 1



# PRODUCT INFORMATION

Products	H	B	L	$P_{max}$	$F_D/P$	weight
incl.:						
1 x GB M10-10E, 3 x SEM 10E, 1 x US 10X30E, 1 x KLR E						

**H:** height  
**B:** width  
**L:** length  
 **$P_{max}$ :** maximum load  
 **$F_D/P$ :** dowel-to-anchor load

## DETAIL AND APPLICATION IMAGES

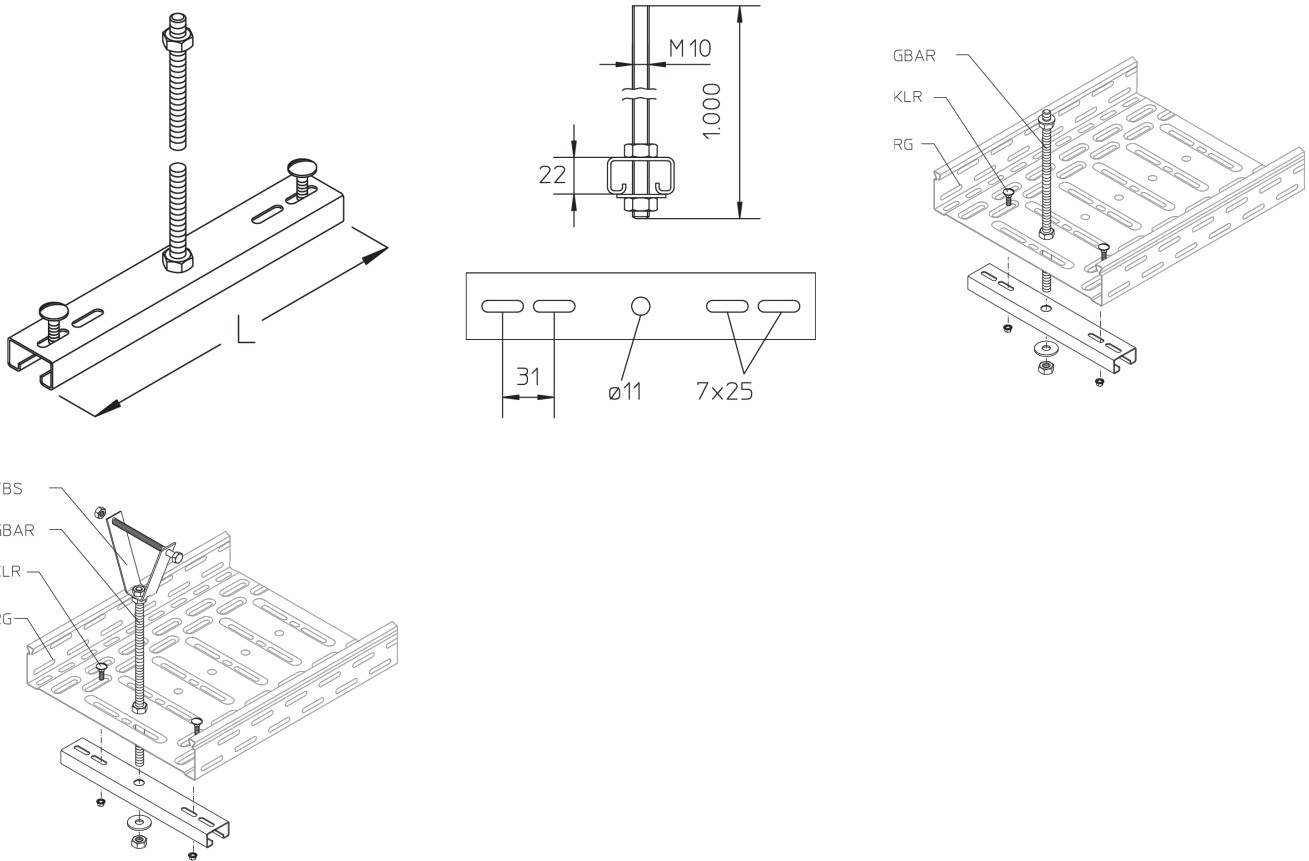

## OPTIONAL ACCESSORIES

SD, SAZ, VM

Page 2



PohlCon GmbH  
 Nobelstraße 51 | 12057 Berlin  
 Telefon: +49 30 68283-04 | Fax: +49 30 68283-383 | [contact@pohlcon.com](mailto:contact@pohlcon.com)





PohlCon GmbH  
Nobelstraße 51 | 12057 Berlin  
Telefon: +49 30 68283-04 | Fax: +49 30 68283-383 | [contact@pohlcon.com](mailto:contact@pohlcon.com)

