

FERBOX® Type E01

Rebend connection, angled hooks parallel to the box

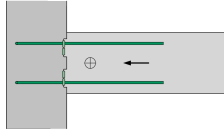

FERBOX® Type E01 single-row rebend connections are used for the frictional connection and reinforcement of reinforced concrete parts. They are suitable for narrow walls from 100 mm wall thick. They have the highest joint category – Interlocked – in transverse and longitudinal directions.. Their studded reinforcement box and cover are made of galvanised sheet metal and the reinforcing bars are made of B500 B or stainless steel. The bars have an L-shape parallel to the box for the first casting section. The FERBOX® box is either 800 or 1200 mm long and 60 to 135 mm wide. The standard diameter of the rods is 8 to 12 mm. Other versions and special solutions are available on request.



Products		weight
512200022702	Ferb E01 60 08 150 0.80	1,536 kg
512200022039	Ferb E01 60 08 150 1.20	2,304 kg
512200022703	Ferb E01 60 08 200 0.80	1,344 kg
512200022040	Ferb E01 60 08 200 1.20	2,016 kg
512200022704	Ferb E01 60 08 250 0.80	1,152 kg
512200022041	Ferb E01 60 08 250 1.20	1,728 kg
512200022706	Ferb E01 60 10 150 0.80	2,368 kg
512200022043	Ferb E01 60 10 150 1.20	3,552 kg
512200022707	Ferb E01 60 10 200 0.80	1,920 kg
512200022044	Ferb E01 60 10 200 1.20	2,880 kg
512200022708	Ferb E01 60 10 250 0.80	1,840 kg
512200022045	Ferb E01 60 10 250 1.20	2,760 kg
512200022701	Ferb E01 85 08 100 0.80	2,320 kg
512200022038	Ferb E01 85 08 100 1.20	3,480 kg
512200022705	Ferb E01 85 10 100 0.80	3,384 kg
512200022042	Ferb E01 85 10 100 1.20	5,076 kg
512200022709	Ferb E01 85 12 100 0.80	5,184 kg
512200022046	Ferb E01 85 12 100 1.20	7,776 kg
512200022710	Ferb E01 85 12 150 0.80	3,712 kg
512200022047	Ferb E01 85 12 150 1.20	5,568 kg



PRODUCT INFORMATION

Products		weight
512200022711	Ferb E01 85 12 200 0.80	2,752 kg
512200022048	Ferb E01 85 12 200 1.20	4,128 kg
512200022712	Ferb E01 85 12 250 0.80	3,040 kg
512200022049	Ferb E01 85 12 250 1.20	4,560 kg

DETAIL AND APPLICATION IMAGES

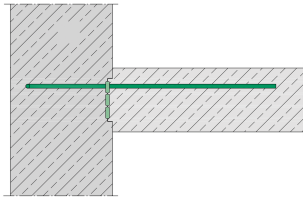

ETA

, ETA-20/0842

