

## BODO N4

Single outlet with two floor sockets, wet-clean, round

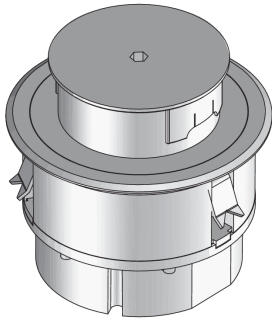

The BODO N4 components are round single outlets with a floor covering protection. They are equipped with a swivelling tube as a cable outlet, a cover, a mounting box with a strain relief device and two Schuko sockets. The single outlets are suitable for dry-cleaned and wet-cleaned rooms with high traffic loads and can be installed in screed and raised or false floor openings. The tube with cover and tube holder is made of aluminium, brass or stainless steel, material no. 1.4301 (V2A). The frame and the mounting box are made of plastic. The single outlets are available in different sizes depending on the material.



Products	H <sub>min</sub>	E	P <sub>max</sub>	IP <sub>g</sub>	IP <sub>n</sub>	color	weight
BODO N4	87 mm	122 mm	15,00 kN	IP-43	IP-66	ALUMINIUM	0,741 kg
incl.:							
1 × UET80-R-WD, 1 × UETD80-R-WD, 1 × UST45-W 2, 1 × UARM-4-1 118, 1 × UG-R, 2 × UGM1-3, 1 × UWZ-IS 8							
BODO N4-CR	87 mm	122 mm	15,00 kN	IP-43	IP-66	CHROM	0,741 kg
incl.:							
1 × UET80-R-WD, 1 × UETD80-R-WD, 1 × UST45-W 2, 1 × UARM-4-1 118, 1 × UG-R, 2 × UGM1-3, 1 × UWZ-IS 8							
BODO N4-E	87 mm	122 mm	15,00 kN	IP-43	IP-66	EDELSTAHL-MASSIV	1,489 kg
incl.:							
1 × UST45-W 2, 1 × UARM-4-1 118, 1 × UG-R, 2 × UGM1-3, 1 × UWZ-IS 8, 1 × UET80-R-WD, 1 × UETD80-R-WD							
BODO N4-MMS	87 mm	122 mm	15,00 kN	IP-43	IP-66	MESSING-MASSIV	1,567 kg
incl.:							
1 × UET80-R-WD, 1 × UETD80-R-WD, 1 × UST45-W 2, 1 × UARM-4-1 118, 1 × UG-R, 2 × UGM1-3, 1 × UWZ-IS 8							
BODO N4-SW	87 mm	122 mm	15,00 kN	IP-43	IP-66	SCHWARZ	0,741 kg
incl.:							
1 × UG-R, 2 × UGM1-3, 1 × UWZ-IS 8, 1 × UET80-R-WD, 1 × UETD80-R-WD, 1 × UST45-W 2, 1 × UARM-4-1 118							



# PRODUCT INFORMATION

$H_{min}$ : minimum installation height  
 $E$ : fitting dimension  
 $P_{max}$ : maximum load  
 $IP_g$ : IP protection level in used condition  
 $IP_n$ : IP protection level in unused condition

## DETAIL AND APPLICATION IMAGES

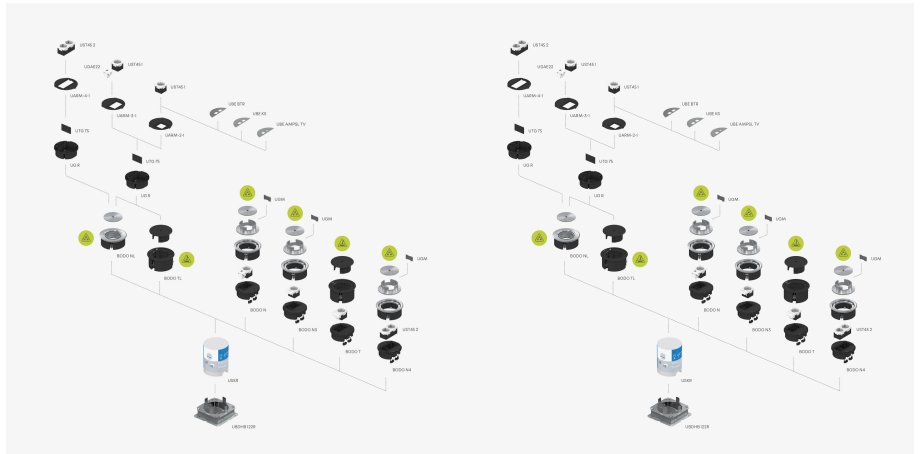
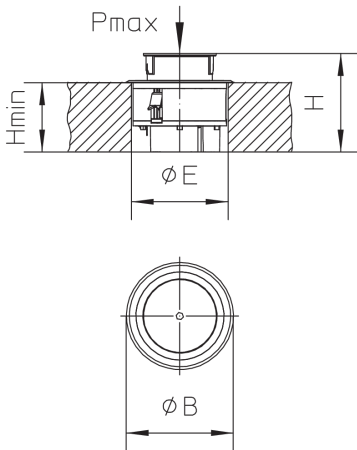

## OPTIONAL ACCESSORIES

USK R122, UBDHB 122R



wet maintained



dry maintained



Load requirements according to, DIN EN 50085

