

BODO N3

Single outlet with one floor socket, wet-clean, round

The BODO N3 components are round single outlets with a floor covering protection frame. They are equipped with a swivelling tube as a cable outlet, a mounting box, a protective socket and a data dummy cover for a Keystone module. The single outlets are suitable for dry-cleaned and wet-cleaned rooms with high traffic loads and can be installed in screed and raised or false floor openings. The tube with cover and tube holder is made of aluminium, brass or stainless steel, material no. 1.4301 (V2A). The frame and the mounting box are made of plastic. The single outlets are available in different sizes depending on the material.



Products	H _{min}	E	P _{max}	IP _g	IP _n	color	weight
BODO N3	87 mm	122 mm	15,00 kN	IP-43	IP-66	ALUMINIUM	0,719 kg
incl.:							
1 × UARM-3-1 118, 1 × UG-R, 2 × UGM1-3, 1 × UDA22-KS 1, 1 × UWZ-IS 8, 1 × UET80-R-WD, 1 × UETD80-R-WD, 1 × UST45-W 1, 1 × UTG 75							
BODO N3-CR	87 mm	122 mm	15,00 kN	IP-43	IP-66	CHROM	0,719 kg
incl.:							
1 × UST45-W 1, 1 × UTG 75, 1 × UARM-3-1 118, 1 × UG-R, 2 × UGM1-3, 1 × UDA22-KS 1, 1 × UWZ-IS 8, 1 × UET80-R-WD, 1 × UETD80-R-WD							
BODO N3-E	87 mm	122 mm	15,00 kN	IP-43	IP-66	EDELSTAHL-MASSIV	1,467 kg
incl.:							
1 × UET80-R-WD, 1 × UETD80-R-WD, 1 × UST45-W 1, 1 × UTG 75, 1 × UARM-3-1 118, 1 × UG-R, 2 × UGM1-3, 1 × UDA22-KS 1, 1 × UWZ-IS 8							
BODO N3-MMS	87 mm	122 mm	15,00 kN	IP-43	IP-66	MESSING-MASSIV	1,545 kg
incl.:							
1 × UET80-R-WD, 1 × UETD80-R-WD, 1 × UST45-W 1, 1 × UTG 75, 1 × UARM-3-1 118, 1 × UG-R, 2 × UGM1-3, 1 × UDA22-KS 1, 1 × UWZ-IS 8							



PRODUCT INFORMATION

Products	H _{min}	E	P _{max}	IP _g	IP _n	color	weight
BODO N3-SW	87 mm	122 mm	15,00 kN	IP-43	IP-66	SCHWARZ	0,719 kg
incl.:							
1 × UDA22-KS 1, 1 × UWZ-IS 8, 1 × UET80-R-WD, 1 × UETD80-R-WD, 1 × UST45-W 1, 1 × UTG 75, 1 × UARM-3-1 118, 1 × UG-R, 2 × UGM1-3							

H_{min}: minimum installation height
E: fitting dimension
P_{max}: maximum load
IP_g: IP protection level in used condition
IP_n: IP protection level in unused condition

DETAIL AND APPLICATION IMAGES

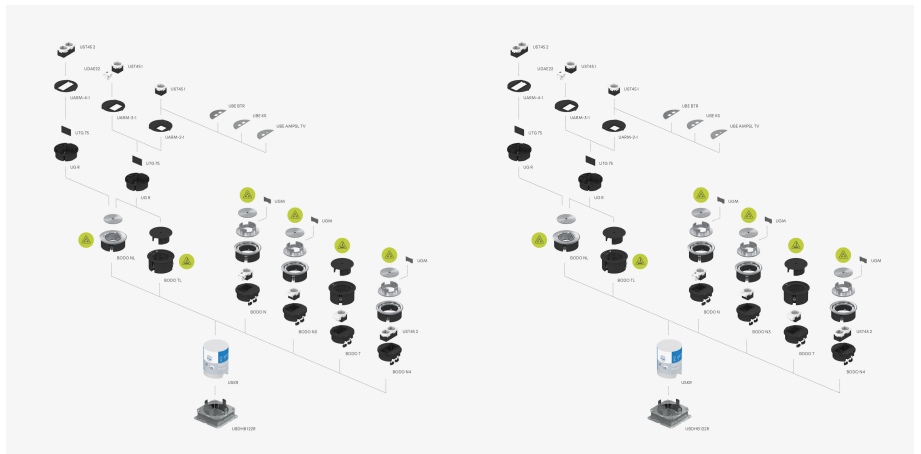
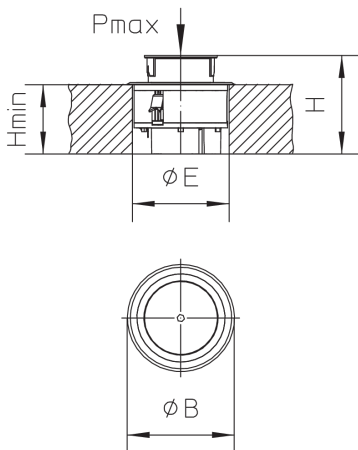

OPTIONAL ACCESSORIES

USK R122, UBDHB 122R



wet maintained



dry maintained

DIN

Load requirements according to, DIN EN 50085

