

## BODO N

Single outlet with one floor socket and one data module, wet-clean, round

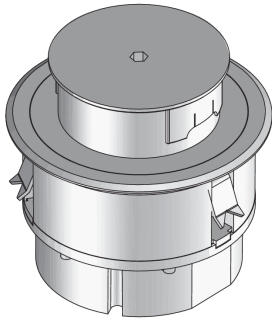

The BODO N components are round single outlets with a floor covering protection frame. They are equipped with a swivelling tube as a cable outlet, a mounting box, a protective socket and an RJ45 data socket. The single outlets are suitable for dry-cleaned and wet-cleaned rooms with high traffic loads and can be installed in screed and raised or false floor openings. The tube with cover and tube holder is made of aluminium, brass or stainless steel, material no. 1.4301 (V2A). The frame and the mounting box are made of high-quality plastic. The single outlets are available in different sizes depending on the material.



Products	H <sub>min</sub>	E	P <sub>max</sub>	IP <sub>g</sub>	IP <sub>n</sub>	color	weight
BODO N	87 mm	122 mm	15,00 kN	IP-43	IP-66	ALUMINIUM	0,744 kg
incl.:							
1 × UET80-R-WD, 1 × UETD80-R-WD, 1 × UDAE22-CAT6 8, 1 × UST45-W 1, 1 × UTG 75, 1 × UARM-3-1 118, 1 × UG-R, 2 × UGM1-3, 1 × UWZ-IS 8							
BODO N-CR	87 mm	122 mm	15,00 kN	IP-43	IP-66	CHROM	0,744 kg
incl.:							
1 × UET80-R-WD, 1 × UETD80-R-WD, 1 × UDAE22-CAT6 8, 1 × UST45-W 1, 1 × UTG 75, 1 × UARM-3-1 118, 1 × UG-R, 2 × UGM1-3, 1 × UWZ-IS 8							
BODO N-E	87 mm	122 mm	15,00 kN	IP-43	IP-66	EDELSTAHL-MASSIV	1,492 kg
incl.:							
1 × UET80-R-WD, 1 × UETD80-R-WD, 1 × UDAE22-CAT6 8, 1 × UST45-W 1, 1 × UTG 75, 1 × UARM-3-1 118, 1 × UG-R, 2 × UGM1-3, 1 × UWZ-IS 8							
BODO N-MMS	87 mm	122 mm	15,00 kN	IP-43	IP-66	MESSING-MASSIV	1,570 kg
incl.:							
1 × UDAE22-CAT6 8, 1 × UST45-W 1, 1 × UTG 75, 1 × UARM-3-1 118, 1 × UG-R, 2 × UGM1-3, 1 × UWZ-IS 8, 1 × UET80-R-WD, 1 × UETD80-R-WD							
BODO N-SW	87 mm	122 mm	15,00 kN	IP-43	IP-66	SCHWARZ	0,744 kg
incl.:							
1 × UARM-3-1 118, 1 × UG-R, 2 × UGM1-3, 1 × UWZ-IS 8, 1 × UET80-R-WD, 1 × UETD80-R-WD, 1 × UDAE22-CAT6 8, 1 × UST45-W 1, 1 × UTG 75							

Page 1



# PRODUCT INFORMATION

$H_{min}$ : minimum installation height  
 $E$ : fitting dimension  
 $P_{max}$ : maximum load  
 $IP_g$ : IP protection level in used condition  
 $IP_n$ : IP protection level in unused condition

## DETAIL AND APPLICATION IMAGES

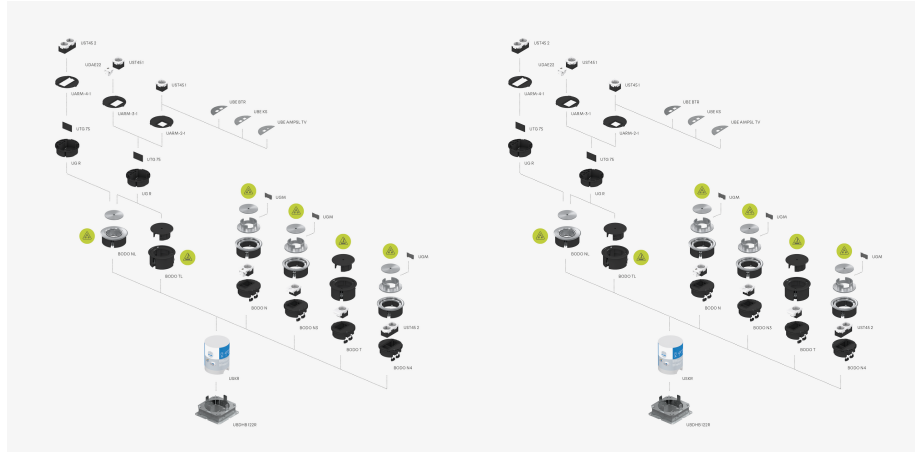
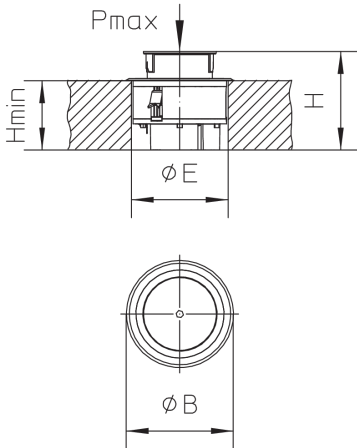

## OPTIONAL ACCESSORIES

USK R122, UDKS 20-50, UBDHB 122R



wet maintained



dry maintained



Load requirements according to, DIN EN 50085

