

## AVE

Rail connector, corner

The channel connector corner AVE can be used to connect mounting channels together as branches. We provide components in various materials and surface finishes to ensure that the corrosion requirements are met for all sorts of applications.

steel, batch/hot-dip galvanized

Products	H	B	t	W
AVE F	90 mm	88 mm	6,00 mm	0,270 kg

**H:** height  
**B:** width  
**t:** material thickness  
**W:** Weight per storage unit

## DETAIL AND APPLICATION IMAGES

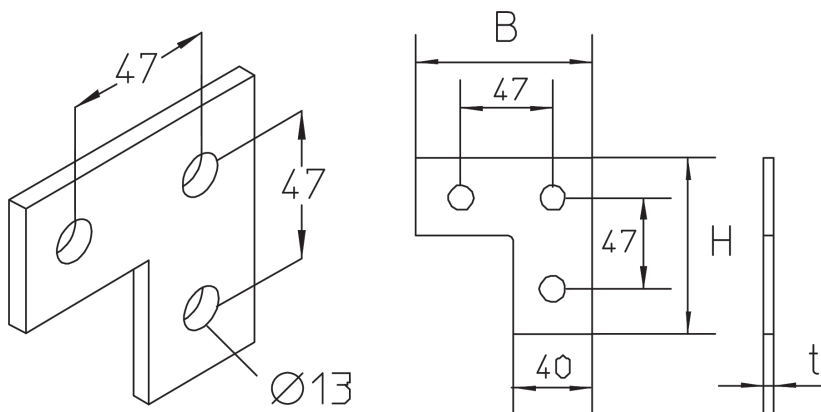

## OPTIONAL ACCESSORIES

SES, AM 22, AMF 22

