

## AMF 22

### Channel nut with spring

AMF 22 channel nuts with springs are threaded plates used with mounting channels A 41, KHA 41 and KHAL 41. The threaded hole is centred by turning the nut 90° after inserting or tipping in the nut. Channel nuts, also known as locking plates, are primarily used for spaced mounting in conjunction with long bolts or threaded rods. The spring holds the channel nut in place. AMF 22 are available with M6, M8, M10 and M12 threads. We provide components in various materials and surface finishes to ensure that various corrosion protection requirements for different areas of application are met.

#### steel, galvanic zinc plated

Products	ø	t	W
AMF22 M6	6 mm	6,00 mm	0,028 kg
AMF22 M8	8 mm	6,00 mm	0,027 kg
AMF22 M10	10 mm	8,00 mm	0,034 kg
AMF22 M12	12 mm	9,50 mm	0,036 kg

#### steel, batch/hot-dip galvanized

Products	ø	t	W
AMF22 M6F	6 mm	6,00 mm	0,029 kg
AMF22 M8F	8 mm	6,00 mm	0,029 kg
AMF22 M10F	10 mm	8,00 mm	0,034 kg
AMF22 M12F	12 mm	9,50 mm	0,036 kg

#### Stainless steel, according to ASTM 316 Ti / AISI 316 L, BS 320S17 / BS 316S11

Products	ø	t	W
AMF22 M6E4	6 mm	6,00 mm	0,027 kg
AMF22 M8E4	8 mm	6,00 mm	0,029 kg
AMF22 M10E4	10 mm	8,00 mm	0,035 kg

Page 1



# PRODUCT INFORMATION

---

Products	Ø	t	W
AMF22 M12E4	12 mm	9,50 mm	0,035 kg

Ø: thread diameter  
t: material thickness  
W: Weight per storage unit

## DETAIL AND APPLICATION IMAGES

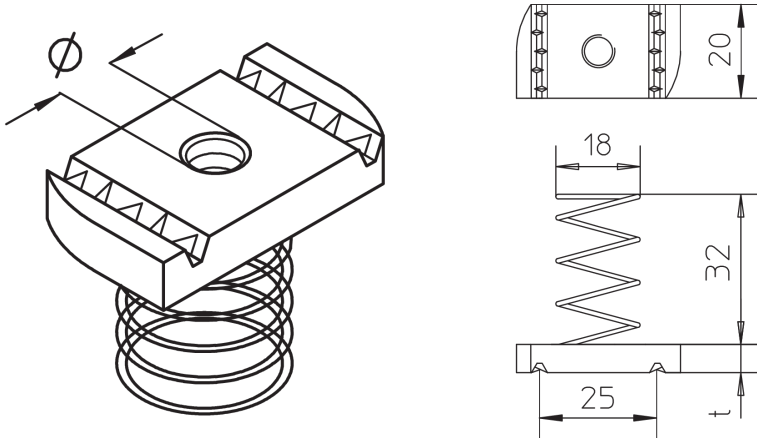

## OPTIONAL ACCESSORIES

A 41, KHA 41, KHAL 41

