

# PRODUCT INFORMATION

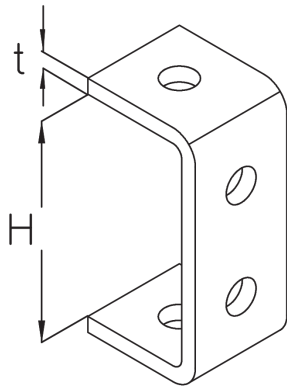

## AKL Rail clamp

The channel clamp AKL is attached to the channel and is used, among other things, for suspension using a threaded rod. It is made of hot-dip galvanized steel.

steel, batch/hot-dip galvanized

Products	H	B	L	t		W
AKL 41F	96 mm	40 mm	47 mm	6,00 mm	0 °	0,320 kg

**H:** height  
**B:** width  
**L:** length  
**t:** material thickness  
**W:** Weight per storage unit

## DETAIL AND APPLICATION IMAGES

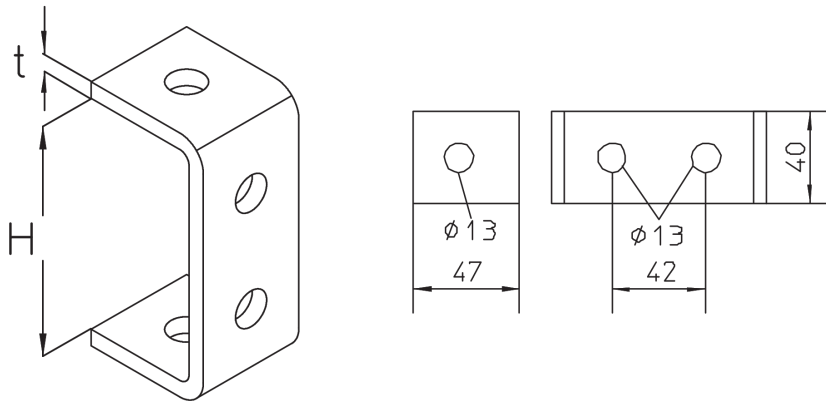

## OPTIONAL ACCESSORIES

SES, AM 22, AMF 22, KHA 41, GB, SEM

