

## AGW

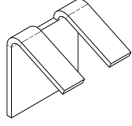

The AGW compensating bracket is used to compensate for unevenness so that the JVAeco+ brickwork support bracket is force-fitted and horizontal against the shell. To do this, it is pushed over the welded-on pressure plate on the underside of the bracket at the pressure point. Assembly is simple and does not require additional tools. The AGW compensating bracket is made of Lean Duplex stainless steel and is available in material from 2 to 6 mm thick.

Products	weight
AGW2	0,023 kg
AGW3	0,034 kg
AGW4	0,058 kg
AGW5	0,073 kg
AGW6	0,087 kg

